



# 建煜風機 THE EXPERT IN BLOWERS CAM YORK BLOWER



ISO 9001:2015

# COMPANY PROFILE & PRODUCT RANGE

## Company Profile

Cam York Industrial Co., Ltd., established in 1972, is a professional manufacturer of centrifugal blowers (also known as multi-blade blowers or Sirocco fans) and impellers (Fan Wheels). Factory area covers an area of approximately 5940 square meter.

Integrity, responsibility as well as professional expertise in producing superior products is our creed, owing to customers' satisfaction and recognition in our quality products.

Due to years experience in blower industries, we manufacture a wide selection of sirocco fan with high quality which can be applied on HVAC system, machinery, air shower, clean room, inflatable products, etc for air suction and discharging. We also got an authentication through the international certification of ISO-9001:2015 Quality assurance.

All developed fans and impellers also have to pass our strict performance test. The performance test facility is corresponding to AMCA (Air Movement and Control Association) standard. We also adopt motor with UL approval to apply on our blowers. Therefore, we assure a high quality performance and low vibration for our product range.

In addition to our standard models, we also welcome customers' special design and specification. In the oversea trading, we sell our products worldwide. So far, we have exported to China, Thailand, Malaysia, Vietnam, United Kingdom, Sweden, Japan, Singapore, USA, Syria, Poland, etc.

With more than 30 years experience, Cam York Industrial Co., Ltd. can produce a high quality products at most competitive price. To be reliable and responsible are always our creeds for serving our customers.

## Characteristics

- The performance test facility is corresponding to AMCA (Air Movement and Control Association) standard.
- 100% Made in Taiwan.
- Computerized dynamic balancing ensure very low vibration during operation.
- Customized requirement is available, upon request.

## Product Range

### A. Blower

Series	Characteristics	Application
CY Series	<ul style="list-style-type: none"> <li>• Single inlet with single fan wheel.</li> <li>• 2 Pole, high speed rotation, high air pressure, high air flow.</li> </ul>	HVAC system for air suction and discharging. Baking machine, packing machine, clean room, kitchen hood, air shower, humidifier, dehumidifier, clean bench, hand dryer, boiler.
DM Series	<ul style="list-style-type: none"> <li>• Double inlet with dual wheel.</li> <li>• High air flow.</li> <li>• Speed controlled device provides different options which makes fan operation more efficiently.</li> </ul>	
M Series	Double fan, double outlet type.	
P / PV Series	4 Pole / 6 Pole, with Foot Mounted motor / Flange Mounted motor.	
CYB Series	BOX type, high pressure, portable, colorful, outdoor design.	
CYT Series	Backward curved impeller, high pressure.	Powder suction, printing machine.
CYV Series	Exhaust fan type design, 3 speed control, remote control. Lower noise. Easier installation.	Indoor ventilation

### B. Fan Wheel

Series	Characteristics	Application
Centrifugal Strip Wheel Centrifugal Tablock Wheel	<ul style="list-style-type: none"> <li>• Impeller is designed in single wheel and dual wheel</li> <li>• Material: steel, galvanized steel, stainless steel, aluminum alloy.</li> <li>• Rotating direction: clockwise, counter clockwise.</li> </ul>	Mainly apply on blower equipment for air suction and discharging.
FFU	High pressure, lower noise, aluminum material.	Clean Room - FFU (fan filter unit)
Turbo / Backward type	Backward curved type	For backward curved type blower.

## Application

Ventilation, Air conditioning, Dryer, Dehumidifier, Inflatable products, etc.

## 公司介紹

建煜工業股份有限公司成立於1972年，為多翼式抽送風機、風輪之專業研發製造商。除了產業界長期使用外，近年來更廣泛運用於無塵室、各式空調系統、各式精密烘箱、烤爐等製程設備之運用。

行銷之國家遍及歐、美、日、澳及東南亞等30餘國；本公司擁有符合美國AMCA標準之風機性能測試機，研發之送風機均經過嚴格的風洞測試，風輪通過電子平衡機檢驗測試；高品質、壽命長，產品適用於空調、乾燥、散熱、冷暖房送風排氣等。

自創立以來，本公司一直秉持著專業化設計生產、行銷，以追求最高品質為自我要求，並以達到客戶100%滿意度為最終目標；並已領先業界通過 ISO-9001:2015 國際品保認證。

展望未來，除了積極提昇技術，更堅持以往的品質信用和口碑，永續經營『品質第一、服務至上、持續改善、創新成長』的品質政策，與客戶共同合作開發新契機。

## 產品特色

- 符合AMCA標準風洞實驗室所設計，製造更佳效能之風機。
- 全機台灣生產製造。
- 風輪100%經電子平衡機校正平衡，震幅，震動最小，運轉平穩，噪音小。
- 可依客戶特殊需求作變更設計。

## 產品介紹

### A. 送風機

系列	特性	應用
CY 系列	• 單入風口，單風輪設計。 • 2 極設計，轉速快，風壓大，風量大。	無塵室,機械,散熱,排氣,廚房吸油煙機,熱循環,烤箱,包裝機,Air Shower,空調系統,機器乾燥,抽風,除濕,烘手機,操作台,鍋爐,咖啡烘豆.
DM 系列	• 雙入風口，雙風輪設計。 • 大風量。 • 速度控制裝置可以提供不同的速度，使整體運轉更有效率。	
M 系列	雙風輪、雙出風口設計。	
P / PV 系列	4極 / 6極馬達，搭配臥式馬達 / 立式馬達 設計。	
CYB 系列	箱型風機設計，攜帶方便，適用於戶外。	充氣拱門，造型玩偶，戶外廣告，氣墊跳床。
CYT 系列	透浦式風輪設計，高靜壓,效率高。	抽送粉塵，塑膠粒，印刷機。
CYV 系列	多翼式排風扇設計，可接風管，方便安裝，三段調速，無線搖控	神明廳，佛堂，吸煙室等室內場所換氣

### B. 風輪

系列	特性	應用
捲齒式 片齒式	• 單風輪，雙風輪設計。 • 材質：鐵，鍍鋅鋼，不鏽鋼，鋁。 • 轉向：順時針，逆時針。	多翼式送風機空氣調節之應用。
FFU	高靜壓，低噪音，鋁材質，FFU 適用。	無塵室。
透浦式	後傾式設計，鐵材質，高靜壓，適用高轉速。	後傾式風機之應用。

## 產品應用

- 通風設備，冷空調，熱空調，乾燥設備，除濕設備，空氣循環，充氣造型氣墊。

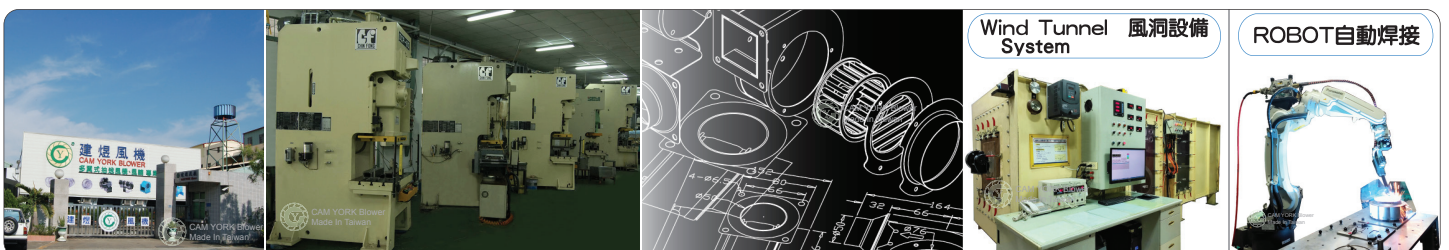



<u>Company Profile &amp; Product Range</u>		01
<u>INDEX</u>		03
<u>Revolution Direction</u>		04
<b>Products Overview</b>		05-06
<u>Centrifugal Strip Wheel Series</u>		07
<u>Centrifugal Tablock Wheel Series</u>		08
<u>CY Series (2 Pole)</u>		09
<b>CYT Series</b> (Backward Curved Impeller)		12
<u>P&amp;PV Series (4 &amp; 6 Pole)</u>		14
<u>M Series</u>		19
<u>DM Series</u>		20
<u>CYS Series</u>		23
<u>CYB Series</u>	 	24
<b>DC Series</b>		25
<u>CYC Smoke Collection Blower</u>		27
<u>CYW 水洗式油煙處理機</u>		28
<u>CYV400 窗型 多翼式排風扇</u>		29
<u>CYV600 輕鋼架型 多翼式排風扇</u>		30
<u>Cross Flow Fan</u>		31
<u>High Pressure Blower</u>		32

## Fan Wheel Rotation Direction / 風輪轉向

- B. or L. or CCW  
(Counter-Clockwise)
- B向 (左旋, 逆時針)

- A. or R. or CW  
(Clockwise)
- A向 (右旋, 順時針)

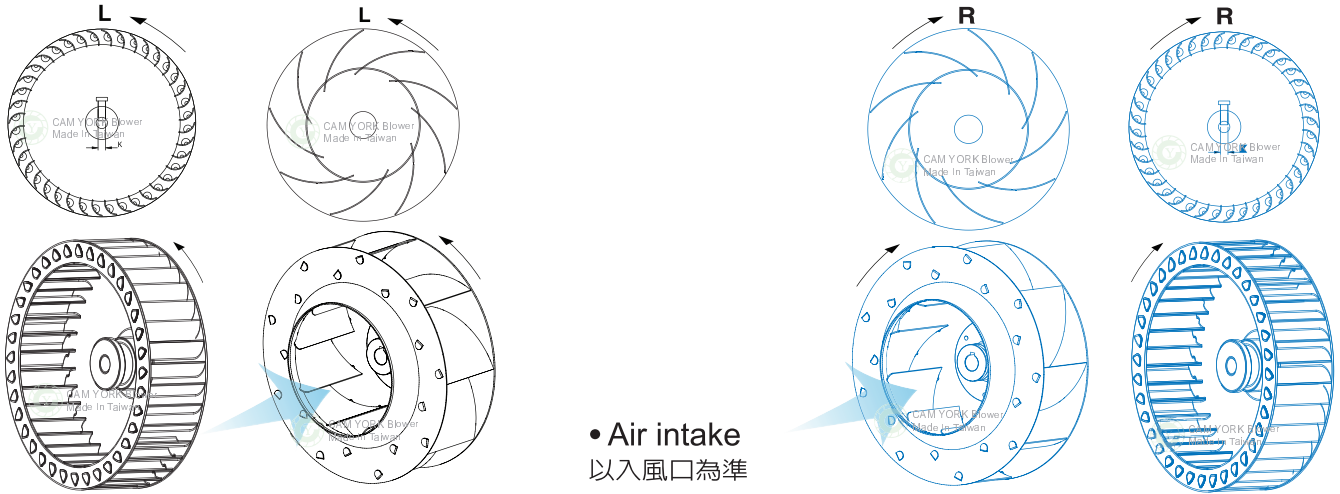

## Blower Rotation Direction / 風車轉向

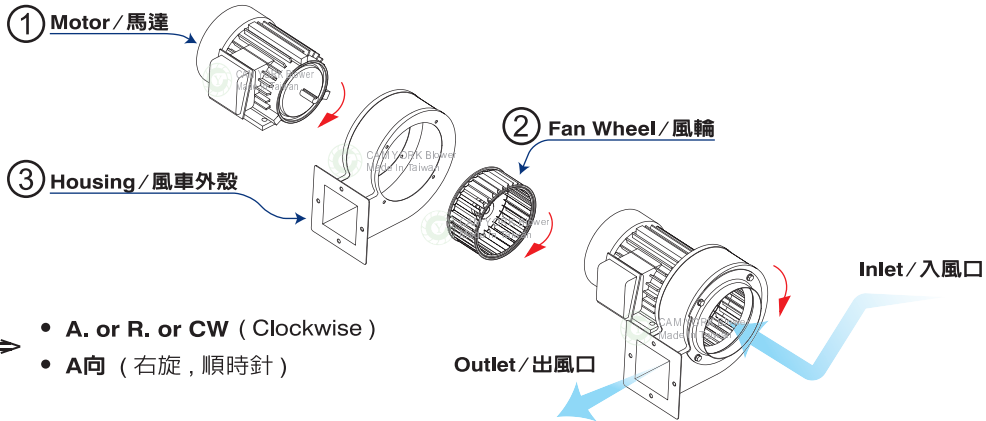

### 組立方向示意圖 (從入風口方向看)

#### 臥式風車 Foot Mounted

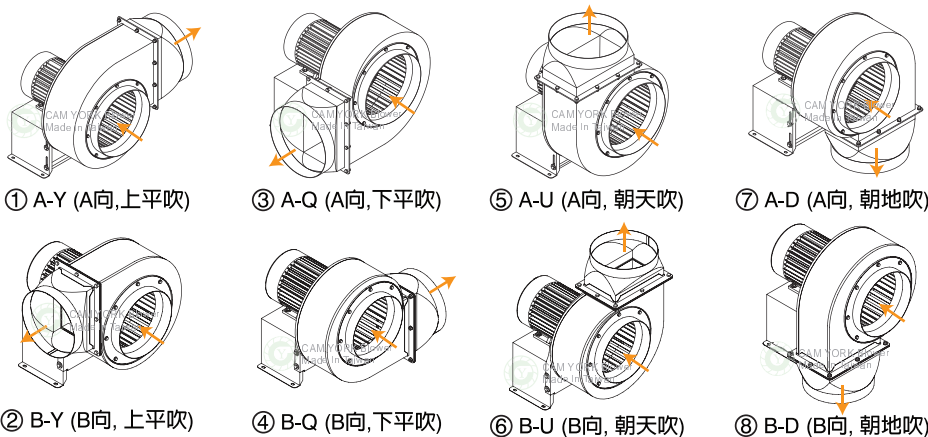

#### 立式風車 Flange Mounted

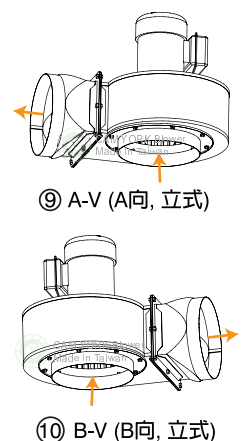

#### DM風車

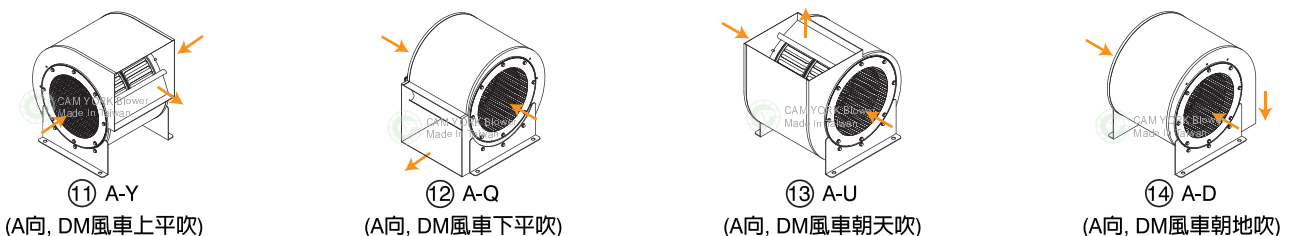

# PRODUCTS OVERVIEW / 產品總覽

## CY series (2 pole)



CY063  
13W (P9)



CY074  
25W (P9)



CY076  
25W (P9)



CY100  
45W (P9)



CY120  
1/8 HP (P10)



CY125  
200W (P10)



CY127  
50W (P10)



CY150  
1/2 HP (P10)



CY180  
1 HP (P11)



CY180AN  
1/2 HP (P11)



CY200  
2 HP, 3HP (P11)



CY200BK  
620W(2P), 100W(4P)(P11)

## CYT series (2 pole)



CYT150  
1/8 HP (P12)



CYT180  
1/8HP (P12)



CYT210  
200W (P12)

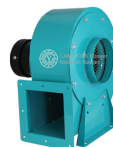

CYT250  
1/2 HP (P12)



CYT275  
1/2 HP (P13)



CYT285  
1 HP (P13)

CYT320  
2 HP (P13)

CYT350  
3 HP (P13)

## P&PV series (4 / 6 pole)



CY125P  
30W (P14)



CY150P  
1/10 HP (P14)



CY180AK  
90W (P14)



CY190P  
1/4 HP (P15)



CY190PV  
1/4 HP (P15)



CY200P  
1/3 HP (P14)



CY210P  
1/4 HP (P15)



P



PV

CY230P/CY230PV  
1/2HP(4P), 1/4HP(6P) (P16)

CY270P/CY270PV  
1 HP(4P), 1/2HP(6P) (P16)

CY310P/CY310PV  
2HP, 3HP(4P), 1HP(6P) (P17)

CY350P  
5HP(4P), 2HP(6P) (P17)

CY380P  
7.5HP(4P), 3HP(6P)  
2HP(8P) (P18)

## M series (2 pole)



CY076M  
45W (P19)



CY100M  
50W (P19)



CY120M  
200W (P19)



CY125M  
1/2 HP (P19)



CY150M  
3/4HP (P20)



CY180M  
1.5HP (P20)

## DM series (4 / 6 pole)



CY125DM 70W (4P) (P20)

CY150DM 110W (4P) (P20)

CY200DM 400W (4P), 110W (6P) (P21)



CY190DM 420W (4P) (P21)

CY230DM 550W (4P), 400W (6P) (P21)

CY270DM 3/4 HP(6P) (P22)



CY178DM 75W(4P) (P21)



CY275DM 1/2 HP(6P) (P22)

CY280DM 3/4 HP(6P) (P22)

CY310DM 700W(6P) (P22)

CY350DM 2 HP(6P) (P23)

## CYB series (2 pole)



CYB120 1/8 HP (P24)



CYB125 200W (P24)



CYB127 50W (P24)



CYB180 1/2 HP (P24)

## CYS series (2 / 4 pole)



CYS190 / CYS193 / CYS195 1/2HP(2P) / 75W(4P) / 1/4HP(4P) (P23)

## DC Brushless series



CY076DC (P25)



CY100DC (P25)



CY120EC (P25)



CY120DC (P25)



CY125DC (P26)



CY100DM EC (P26)



CY152DMDC 塑膠 (P26)

## CYV400/CYV600 多翼式排風扇



CYV400 窗型 (P29)



CYV600 輕鋼架型 (P30)

## CYW250水洗式油煙處理機



(P28)

## CYC380



CYC380 50W (P27)

## Cross flow fan Series (P31)



## High Pressure Series (P32)



# CENTRIFUGAL STRIP WHEEL Series

## Centrifugal Strip Wheel Series / 捲齒系列

### Material / 材質:

- A : steel w/ painting - 鐵
- G : galvanized - 鍍鋅板
- B : aluminum - 鋁
- S : stainless steel - 不鏽鋼

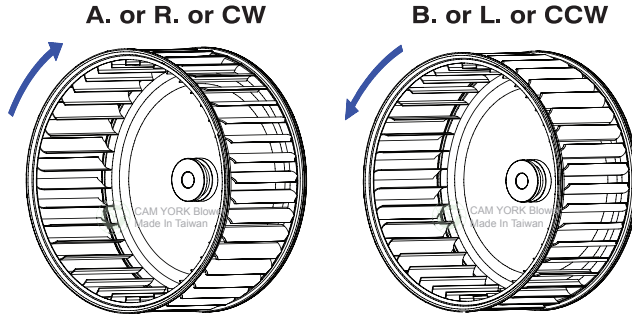
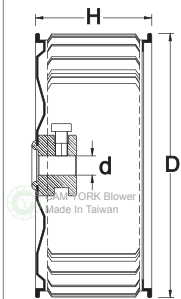

A. or R. or CW



B. or L. or CCW

## Single Wheel

MULTI-BLADE IMPELLER						
SIZE			BORE	KEYWAY	ROTATION	REMARK
(D) (mm)	(D) (inch)	(H) (mm)	(d) (mm)	(K) (mm)	R (CW), L (CCW)	
76	3	40	6/8		R,L	
90	3.5	56	6/8		R,L	
105	4	56	8		R,L	
130	5	56/65/76	8/11/14		R,L	
145	5.6	76/151	12/12.7/14		R,L	
158	6	56/76/97	11/14		R,L	
190	7.5	97	14		R,L	
230	9	118	14/16		R,L	
270	10.5	136	19/24	6x3, 8x4	R,L	
310	12	156	24/28	8x4	R,L	



A. or R. or CW

## Dual Wheel

MULTI-BLADE IMPELLER IN DUAL WHEELS						
SIZE			BORE	KEYWAY	ROTATION	REMARK
(D) (mm)	(D) (inch)	(H) (mm)	(d) (mm)	(K) (mm)	R (CW), L (CCW)	
130	5	152	8		R,L	
145	5.7	200/300	12/12.7		R,L	
158	6	152/200	12/14		R,L	
190	7.5	200	14		R,L	
230	9	236	14/16		R,L	
270	10.5	274	14/19		R,L	
310	12	310	24	8x4	R,L	



## Centrifugal Tablock Wheel Series / 片齒系列

### Material / 材質:

- A** : steel w / painting - 鐵
- G** : galvanized - 鍍鋅板
- B** : aluminum - 鋁
- S** : stainless steel - 不鏽鋼

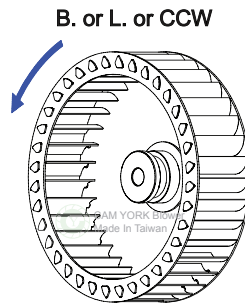
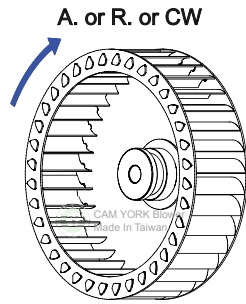
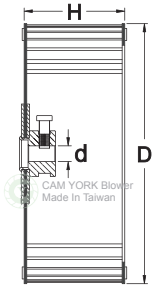

A. or R. or CW



B. or L. or CCW

### Single Wheel

MULTI-BLADE IMPELLER						
SIZE		BORE (d) (mm)	KEYWAY (K) (mm)	ROTATION R (CW), L (CCW)	REMARK	
(D) (mm)	(D) (inch)					
127	5	—	—	R,L		
152	6	—	—	R,L		
170	6.6	—	—	R,L		
178	7	—	—	R,L		
190	7.5	—	—	R,L		
200	8	—	—	R,L		
230	9	—	—	R,L		
248	9.6	—	—	R,L		
270	10.5	—	—	R,L		
280	11	—	—	R,L		
295	11.6	—	—	R,L		
305	12	—	—	R,L		
330	13	—	—	R,L		
356	14	—	—	R,L		
380	15	—	—	R,L		
456	18	—	—	R,L		
533	21	—	—	R,L		
610	24	—	—	R,L		
685	27	—	—	R,L		
763	30	—	—	R,L		

• 孔徑鍵槽各異，以IEC為準，可依客戶規格訂作

### Dual Wheel

- Above TABLOCK MULTI-BLADE IMPELLERS can be conjoined as double-inlet type (Hx2) indicated as C \* B-M impllers
- 片齒雙口M系列可由單一風輪組合而成，高度為單口的兩倍



A. or R. or CW



B. or L. or CCW

### Other Wheel Series



FFU



Backward curved type



Strong Type

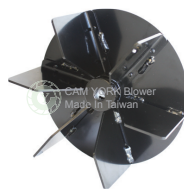

一體成型

# CY Series (2 Pole)

## CY063

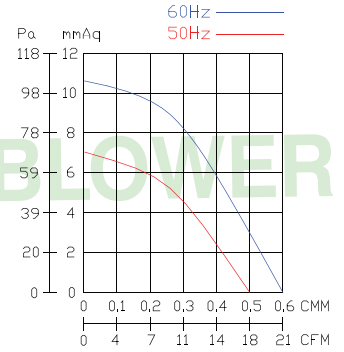
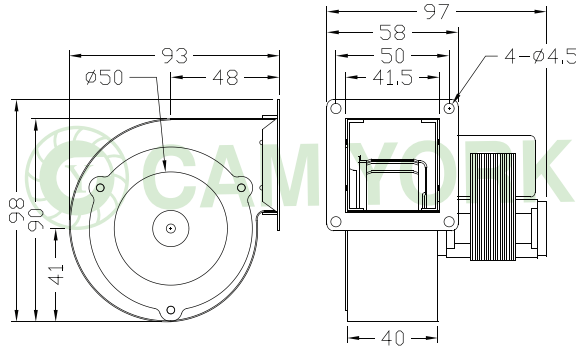

• 敞極馬達 / Shaded pole motor

## CY074

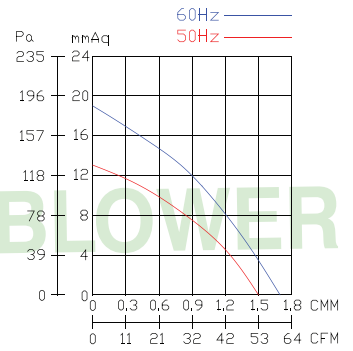
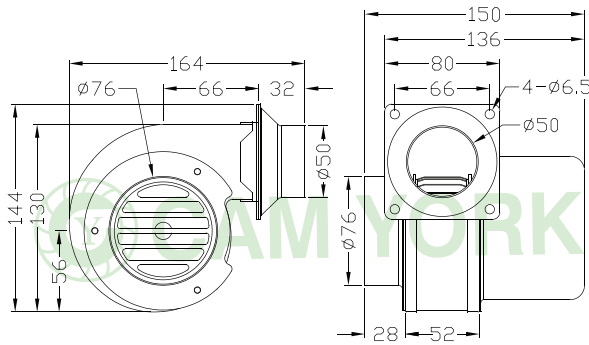

• 敞極馬達 / Shaded pole motor

## CY076

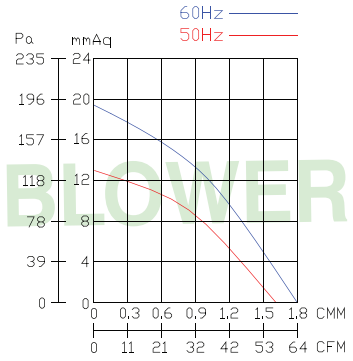
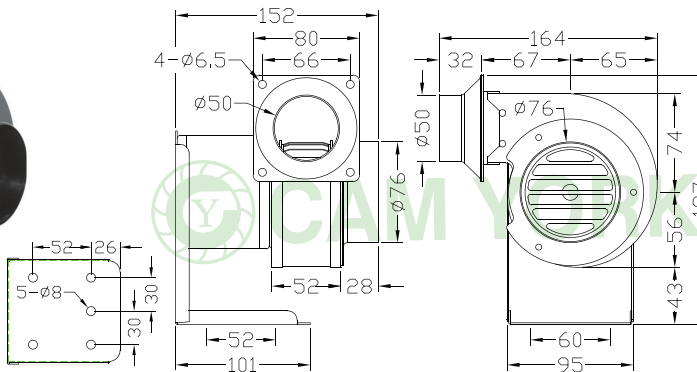

## CY100

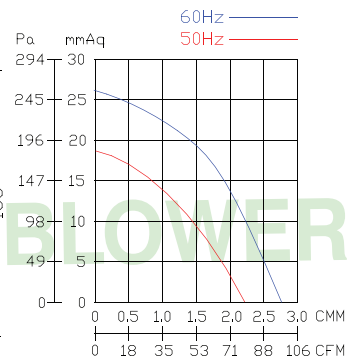
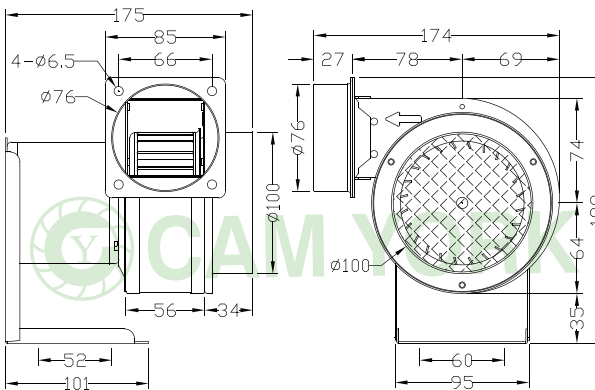
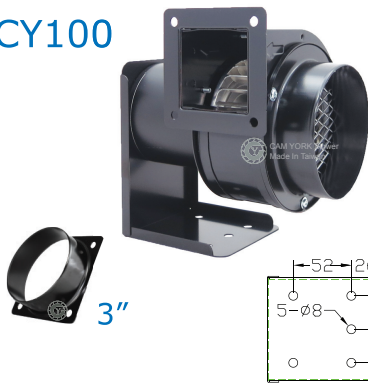

型號	電壓	頻率	相數	極數	電流	馬力	轉速	最大風量			最大靜壓			重量
Model	Rated Voltage	Frequency	Phase	Pole	Current	Power	Speed	Max. Air Flow			Max. Pressure			Weight
	V	Hz	∅	P	A	Watt / HP	R.P.M.	CMM	CMH	CFM	mmAq	inchAq	Pa	KG
CY063	110/220	50	1	2	0.25 / 0.10	13 W	2730	0.5	30	18	7	0.28	69	0.6
		60			0.20 / 0.10		3200	0.6	36	21	10.5	0.41	103	
CY074	110/220	50	1	2	0.86 / 0.34	25 W	2760	1.5	90	53	13	0.51	127	1.6
		60			0.68 / 0.30		3200	1.7	102	60	19	0.75	186	
CY076	110/220	50	1	2	0.35 / 0.17	25 W	2860	1.6	96	56	13	0.51	127	2.0
		60			0.28 / 0.14		3300	1.8	108	64	19	0.75	186	
CY100	110/220	50	1	2	0.60 / 0.30	45 W	2870	2.2	132	78	18	0.71	177	2.4
		60			0.55 / 0.30		3350	2.7	162	95	26	1.02	255	

## CY120

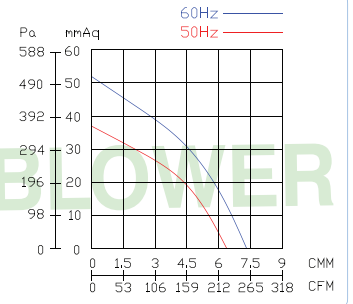
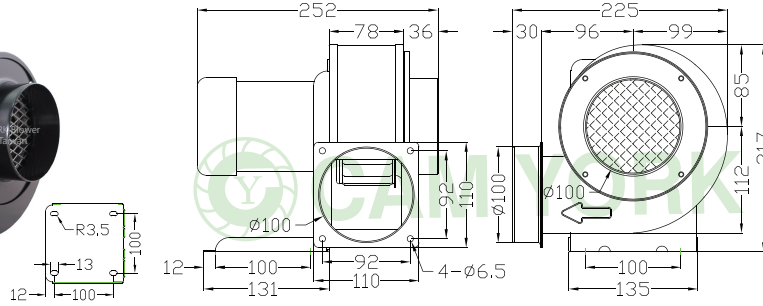

## CY125

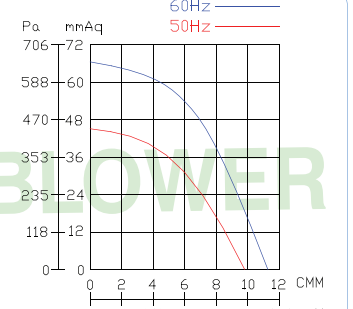
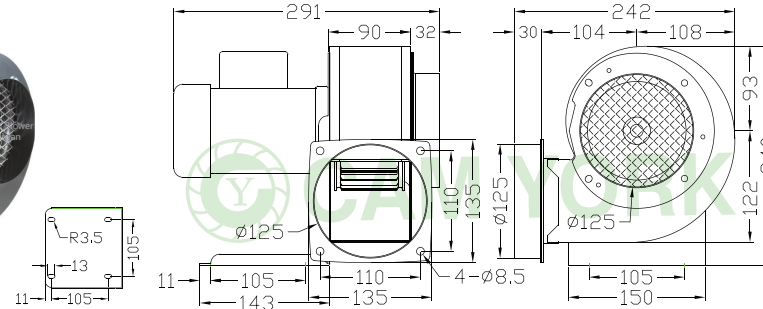

## CY127

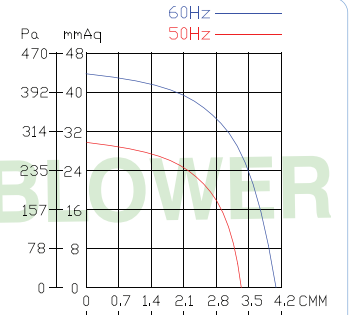
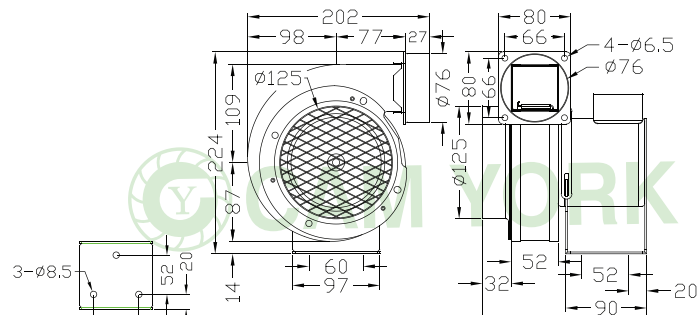

## CY150

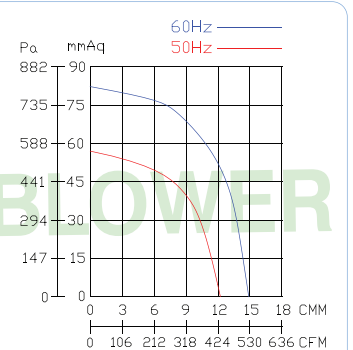
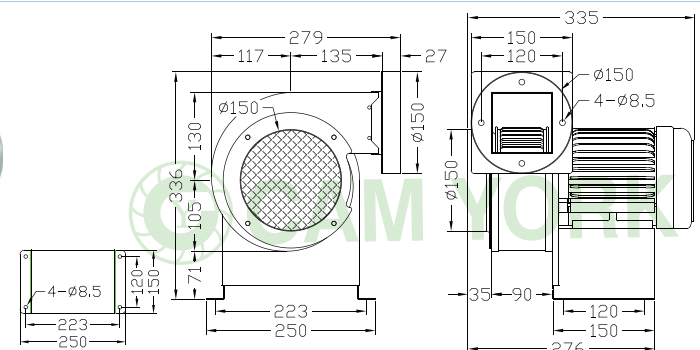

型號	電壓	頻率	相數	極數	電流	馬力	轉速	最大風量			最大靜壓			重量
Model	Rated Voltage	Frequency	Phase	Pole	Current	Power	Speed	Max. Air Flow			Max. Pressure			Weight
	V	Hz	∅	P	A	Watt / HP	R.P.M.	CMM	CMH	CFM	mmAq	inchAq	Pa	KG
CY 120	110/220	50	1	2	1.15 / 0.50	1/8 HP	2870	6.4	384	226	37	1.46	363	4.3
		60			1.35 / 0.65		3330	7.3	438	258	52	2.05	510	
	220/380	50	3	0.5 / 0.3	2870		6.4	384	226	37	1.46	363		
		60		0.5 / 0.3	3330		7.3	438	258	52	2.05	510		
CY 125	110/220	50	1	2	2.4 / 1.2	200 W	2800	9.5	570	335	46	1.81	451	6.1
		60			3.0 / 1.5		3480	11.6	696	409	66.6	2.62	653	
	220/380	50	3	0.8 / 0.45	2800		9.5	570	335	46	1.81	451		
		60		1.0 / 0.55	3480		11.6	696	409	66.6	2.62	653		
CY 127	110/220	50	1	2	1 / 0.5	50 W	2840	3.3	198	116	30.5	1.20	299	3.7
		60			1 / 0.5		3320	4	240	141	44	1.73	432	
	220/380	50	3	0.45 / 0.3	2840		3.3	198	116	30.5	1.20	299		
		60		0.45 / 0.3	3400		4	240	141	44	1.73	432		
CY 150	110/220	50	1	2	5.5 / 2.8	1/2 HP	2930	12.5	750	441	58	2.28	569	16
		60			6.4 / 3.2		3460	14.8	888	522	84	3.31	824	
	220/380	50	3	1.8 / 1.0	2930		12.5	750	441	58	2.28	569		
		60		2.0 / 1.1	3460		14.8	888	522	84	3.31	824		

# CY Series (2 Pole)

## CY180

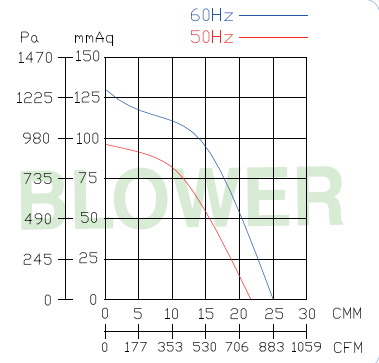
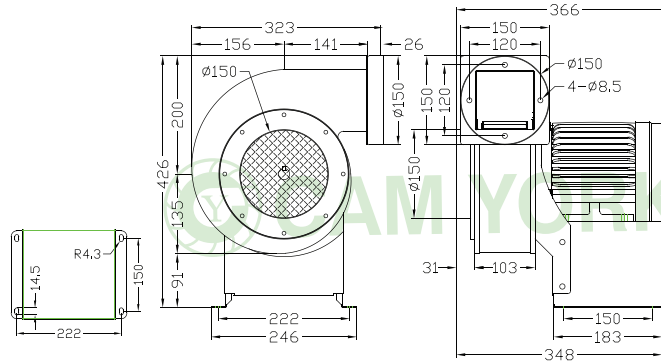

## CY180AN

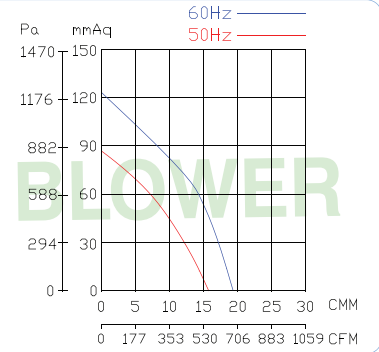
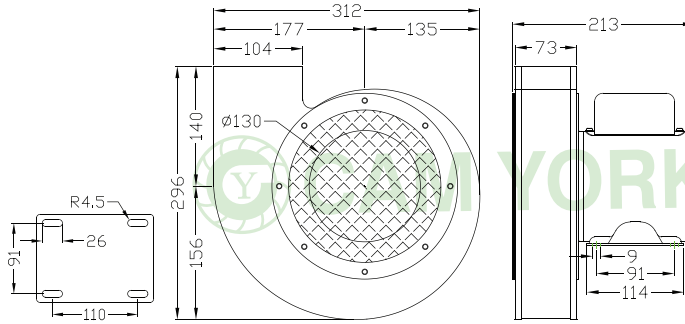

## CY200

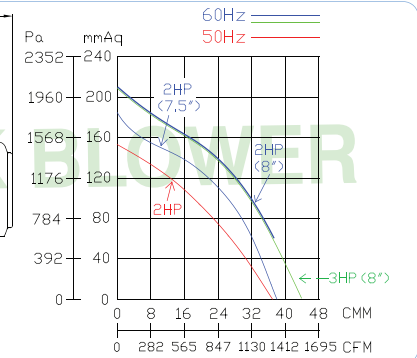
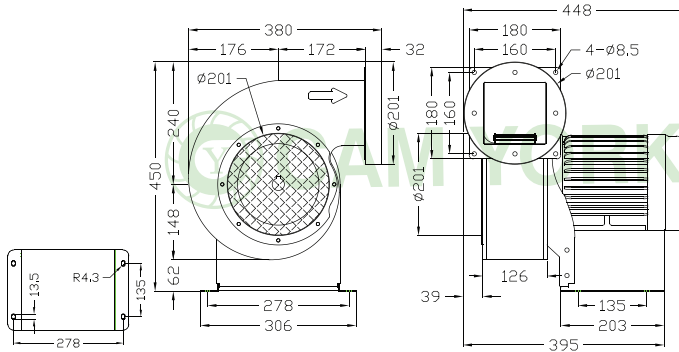

## CY200BK

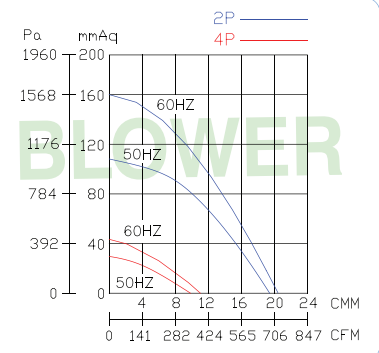
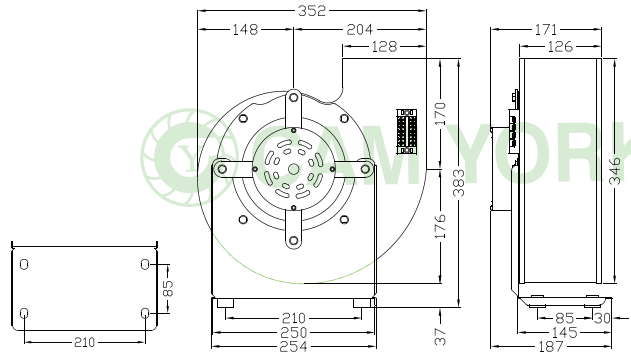

型號	電壓	頻率	相數	極數	電流	馬力	轉速	最大風量			最大靜壓			重量	
Model	Rated Voltage	Frequency	Phase	Pole	Current	Power	Speed	Max. Air Flow			Max. Pressure			Weight	
	V	Hz	Ø	P	A	Watt / HP	R.P.M.	CMM	CMH	CFM	mmAq	inchAq	Pa	KG	
CY180	110/220	50	1	2	8.2 / 4.2	1 HP	2800	21.5	1290	759	92	3.62	902	22	
		60			11.4 / 5.8		3300	25	1500	883	5.12	1275			
	220/380	50	3	3.4 / 2	2800		21.5	1290	759	92	3.62	902	20.5		
		60		4 / 2.3	3300		25	1500	883	5.12	1275				
CY180AN	110/220	50	1	2	6.1 / 3.1	1/2 HP	2850	16	960	565	85	3.35	834	10.5	
		60			8.7 / 4.3		3250	18.3	1098	646	4.82	1201			
CY200	220	50	1	2	8	2 HP	2850	37	2220	1306	152	5.98	1491	31	
		60			10		3380	44	2640	1553	214	8.43	2099		
	220/380	50	3	2	CY 6.1 / 3.3		2850	37	2220	1306	152	5.98	1491	30	
		60			CY 6.8 / 4.2		3380	44	2640	1553	214	8.43	2099		
		60			5.3 / 3		空吹 2HP 7.5"	3450	38	2280	1341	185	7.28		1814
		60			8 / 4.7		3 HP	3480	44	2640	1553	214	8.43		2099
CY200BK	220/380	50	3	2	2.7 / 1.7	620 W	2700	19	1140	671	113	4.45	1108	11.6	
		60			4.0 / 2.4		3000	21.2	1272	748	160	6.30	1569		
		50	4	4	0.8 / 0.45	100 W	1400	9.8	588	346	30.7	1.21	301		
		60			0.8 / 0.47		1640	11.5	690	406	42	1.65	412		

# CYT Series (Backward Curved Impeller) 後傾式

## CYT150

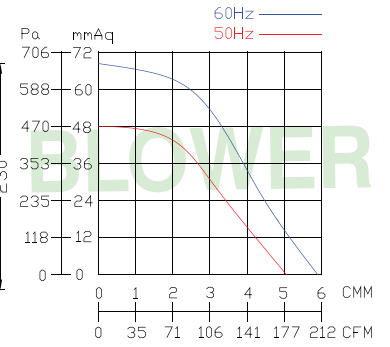
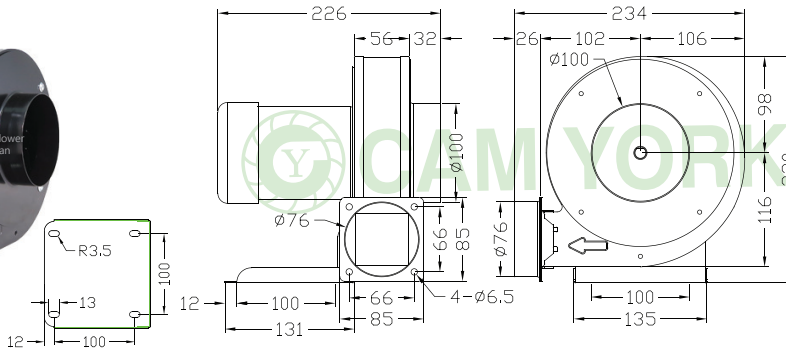

## CYT180

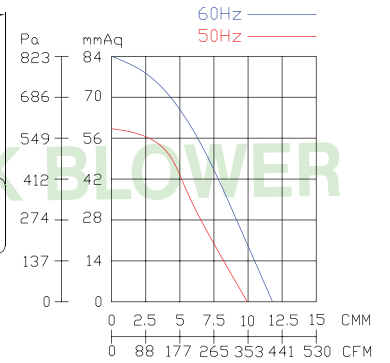
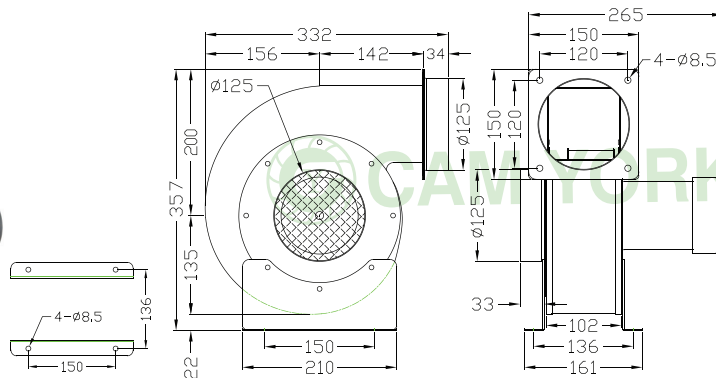

## CYT210

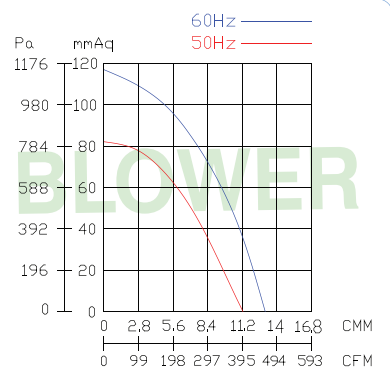
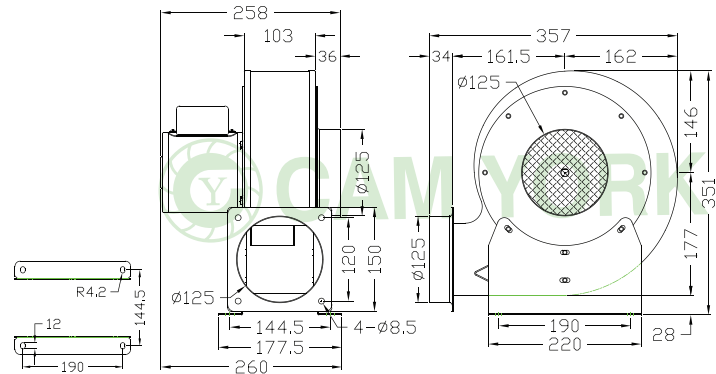

## CYT250

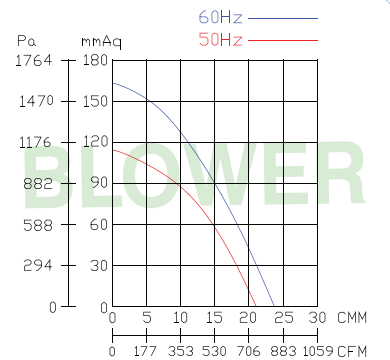
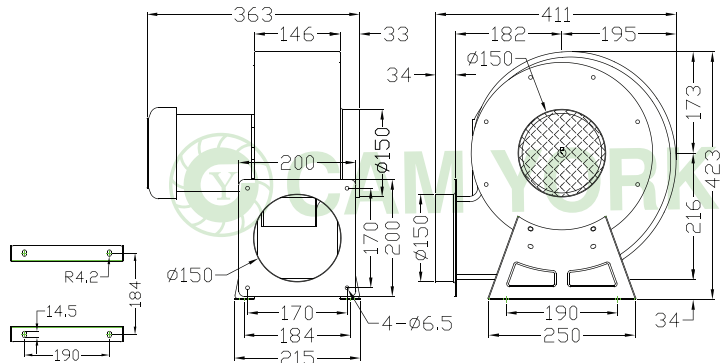

型號	電壓	頻率	相數	極數	電流	馬力	轉速	最大風量			最大靜壓			重量
Model	Rated Voltage	Frequency	Phase	Pole	Current	Power	Speed	Max. Air Flow			Max. Pressure			Weight
	V	Hz	∅	P	A	Watt / HP	R.P.M.	CMM	CMH	CFM	mmAq	inchAq	Pa	KG
CYT150	110/220	50	1	2	1.3 / 0.65	1/8 HP	2850	5.1	306	180	48	1.89	471	5
		60			1.7 / 0.85		3300	5.8	348	205	68	2.68	667	
	220/380	50	0.55 / 0.38		2850		5.1	306	180	48	1.89	471		
		60	0.6 / 0.35		3300		5.8	348	205	68	2.68	667		
CYT180	110/220	50	1	2	1.2 / 0.6	1/8 HP	2880	9.8	588	346	60	2.36	588	7.3
		60			1.4 / 0.7		3340	11.5	690	406	85	3.35	834	
	220/380	50	2 / 1		2870		11	660	388	82	3.23	804		
		60	2.3 / 1.2		3320		12.6	756	445	117	4.61	1147		
CYT210	110/220	50	1	2	0.85 / 0.5	200 W	2870	11	660	388	82	3.23	804	10
		60			0.85 / 0.5		3320	12.6	756	445	117	4.61	1147	
	220/380	50	3		4 / 2		2900	21	1260	741	113	4.45	1108	
		60			5 / 2.7		3400	24	1440	847	160	6.30	1569	
CYT250	110/220	50	1	2	1.2 / 0.7	1/2 HP	2900	21	1260	741	113	4.45	1108	23
		60			1.5 / 0.9		3400	24	1440	847	160	6.30	1569	
	220/380	50	3		4 / 2		2900	21	1260	741	113	4.45	1108	
		60			5 / 2.7		3400	24	1440	847	160	6.30	1569	

# CYT Series (Backward Curved Impeller) 後傾式

## CYT275

3"

## CYT285

## CYST285

6"

6", 8", 10"

## CYT320

8"

## CYT350

8"

型號	電壓	頻率	相數	極數	電流	馬力	轉速	最大風量			最大靜壓			重量
Model	Rated Voltage	Frequency	Phase	Pole	Current	Power	Speed	Max. Air Flow			Max. Pressure			Weight
	V	Hz	∅	P	A	Watt / HP	R.P.M.	CMM	CMH	CFM	mmAq	inchAq	Pa	KG
CYT275	110/220	50	1	2	4 / 2	1/2 HP	2900	9.5	570	335	154	6.06	1510	16.5
		60			5.3 / 2.6		3360	11	660	388	216	8.50	2118	
	220/380	50	2.2 / 1.4		2900		9.5	570	335	154	6.06	1510		
		60	2 / 1.15		3360		11	660	388	216	8.50	2118		
CYT285	110/220	50	1	2	7.6 / 3.8	1 HP	2900	28	1680	988	152	5.98	1491	29
		60			9.4 / 4.7		3400	33	1980	1165	215	8.46	2109	
	220/380	50	2.2 / 1.3		2900		28	1680	988	152	5.98	1491		
		60	3 / 1.7		3400		33	1980	1165	215	8.46	2109		
CYT320	220	50	1	2	8	2 HP	2940	45	2700	1589	183	7.20	1795	45
		60			10		3450	53	3180	1871	263	10.35	2579	
	220/380	50	4.2 / 2.4		2940		45	2700	1589	183	7.20	1795		
		60	5.7 / 3.3		3450		53	3180	1871	263	10.35	2579		
CYT350	220/380	50	3	2	6 / 3.5	3 HP	2960	55	3300	1942	224	8.82	2197	46
		60			8.15 / 4.6		3500	66	3960	2330	327	12.87	3207	

## CY125P

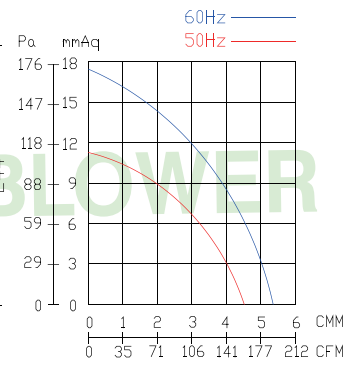
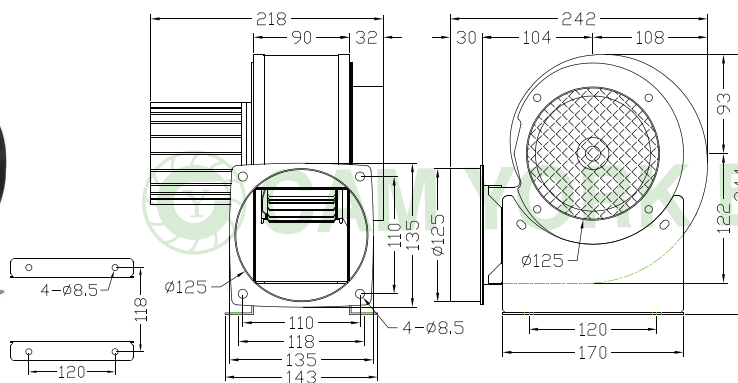

## CY150P

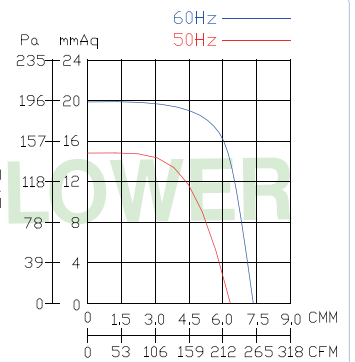
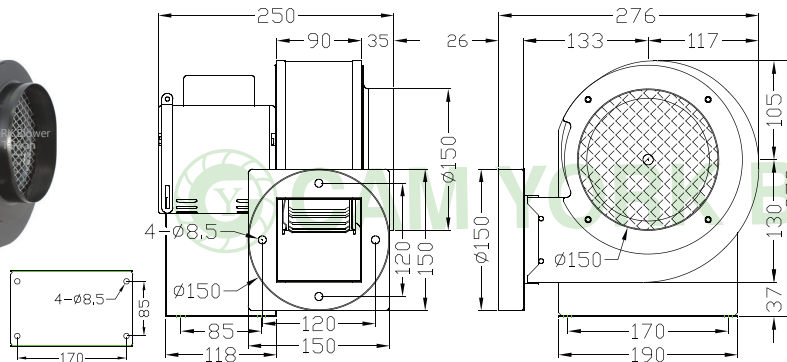
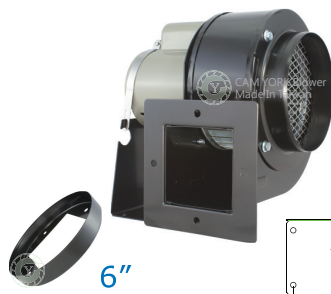

## CY180AK

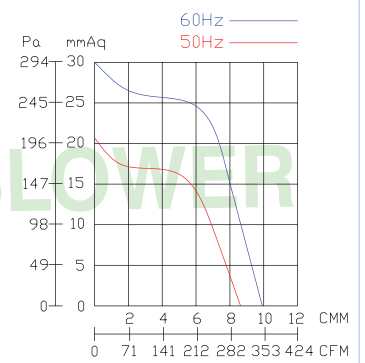
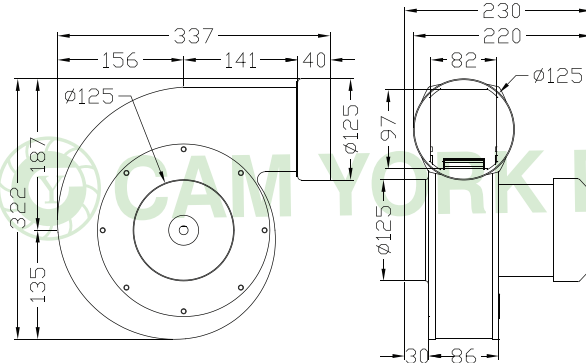

## CY200P

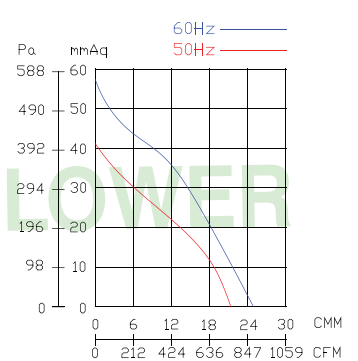
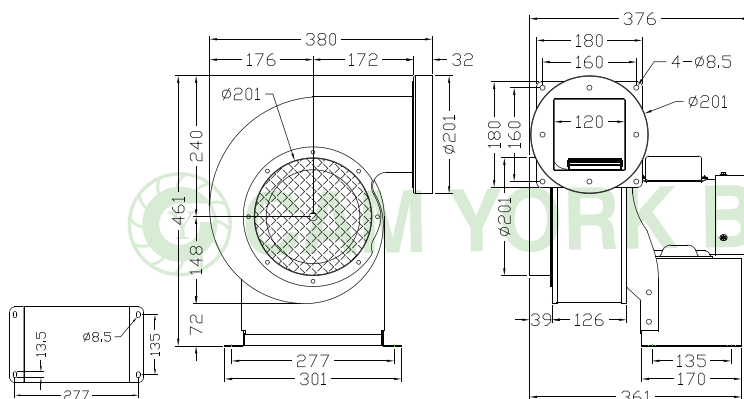

型號	電壓	頻率	相數	極數	電流	馬力	轉速	最大風量			最大靜壓			重量
Model	Rated Voltage	Frequency	Phase	Pole	Current	Power	Speed	Max. Air Flow			Max. Pressure			Weight
	V	Hz	$\phi$	P	A	Watt / HP	R.P.M.	CMM	CMH	CFM	mmAq	inchAq	Pa	KG
CY125P	110/220	50	1	4	0.7 / 0.3	30 W	1400	4.5	270	159	11.1	0.44	109	6.1
		60			0.6 / 0.3		1700	5.3	318	187	17.3	0.68	170	
CY150P	110/220	50	1	4	1.5 / 0.8	1/10 HP	1450	6.2	372	219	14.5	0.57	142	6.2
		60			1.2 / 0.6		1720	7.4	444	261	20	0.79	196	
CY180AK	110	50	1	4	1.7	90 W	1420	8.4	504	297	21	0.83	206	6.5
		60			1.6		1650	9.8	588	346	30.3	1.19	297	
CY200P	110/220	50	1	4	4 / 2	1/3 HP	1470	21.3	1278	752	41	1.61	402	14.5
		60			4 / 2		1740	24.7	1482	872	58	2.28	569	

# P & PV Series (4 Pole & 6 Pole)

## CY190P

## CY190PV

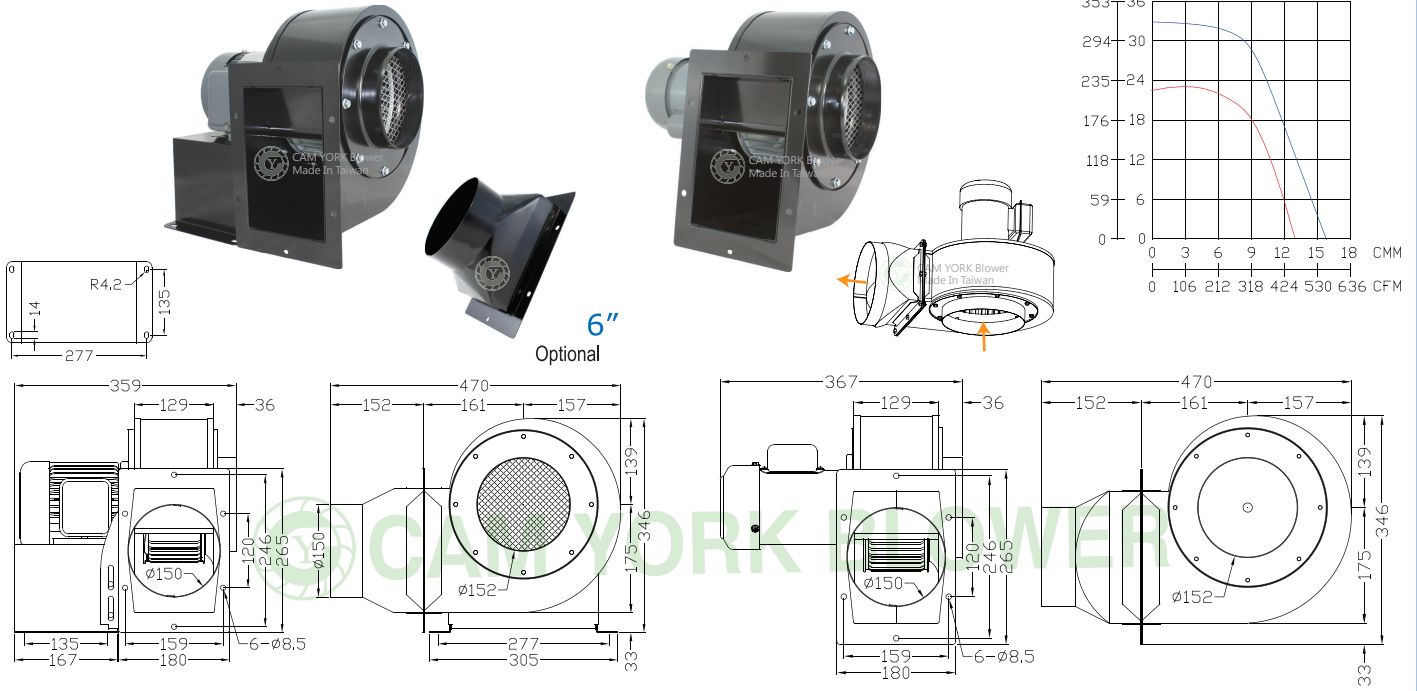

## CY210P

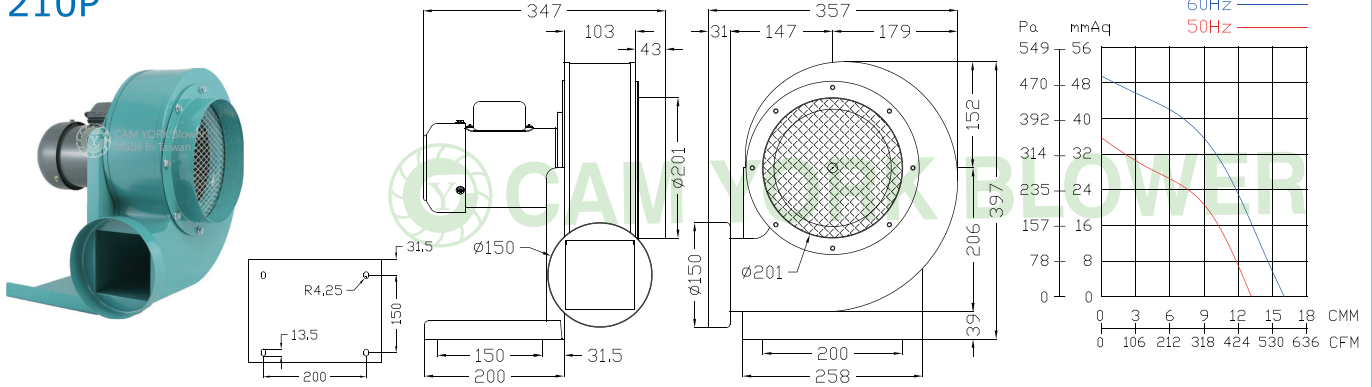

型號	電壓	頻率	相數	極數	電流	馬力	轉速	最大風量			最大靜壓			重量	
Model	Rated Voltage	Frequency	Phase	Pole	Current	Power	Speed	Max. Air Flow			Max. Pressure			Weight	
	V	Hz	∅	P	A	Watt / HP	R.P.M.	CMM	CMH	CFM	mmAq	inchAq	Pa	KG	
CY190P	110/220	50	1	4	2.7 / 1.4	1/4 HP	1460	12.5	750	441	23.3	0.92	229	16.5	
		60			2.5 / 1.3		1720	15.3	918	540	33.5	1.32	329		
CY190PV	220/380	50	3		1 / 0.6		1460	12.5	750	441	23.3	0.92	229		12.4
		60			1 / 0.6		1720	15.3	918	540	33.5	1.32	329		
CY210P	110/220	50	1	4	3 / 1.5	1/4 HP	1460	13.7	822	484	34.5	1.36	338	13.3	
		60			3 / 1.5		1710	16.3	978	575	50.8	2.00	498		



# P & PV Series (4 Pole & 6 Pole)

## CY230P

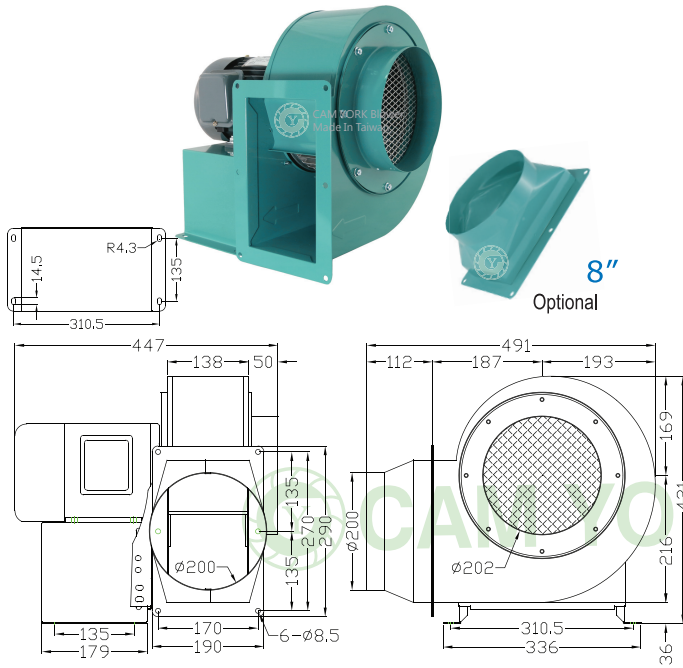

## CY230PV

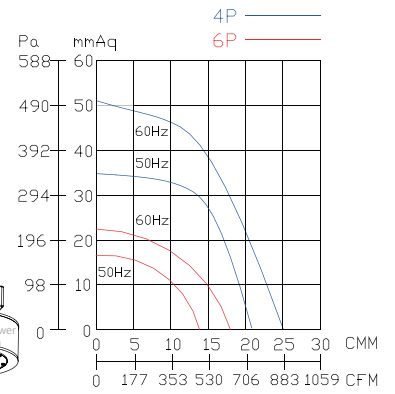
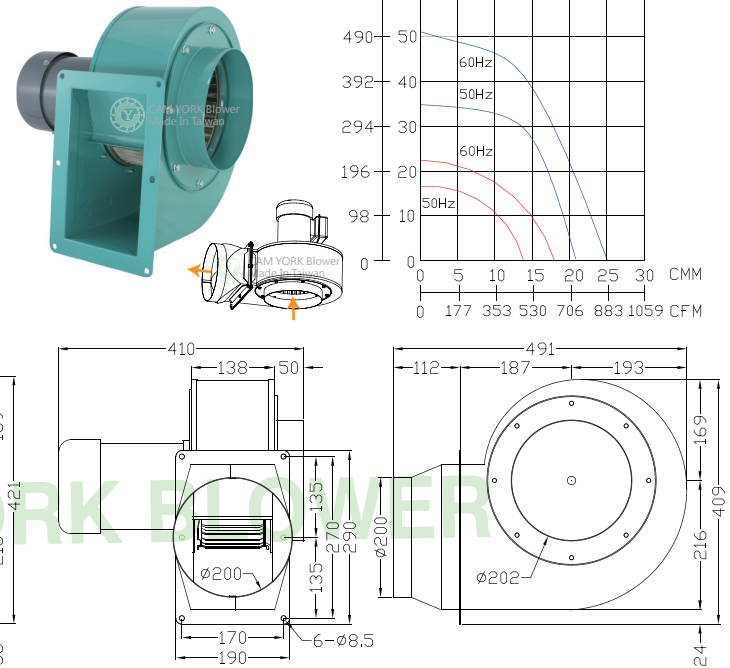

## CY270P

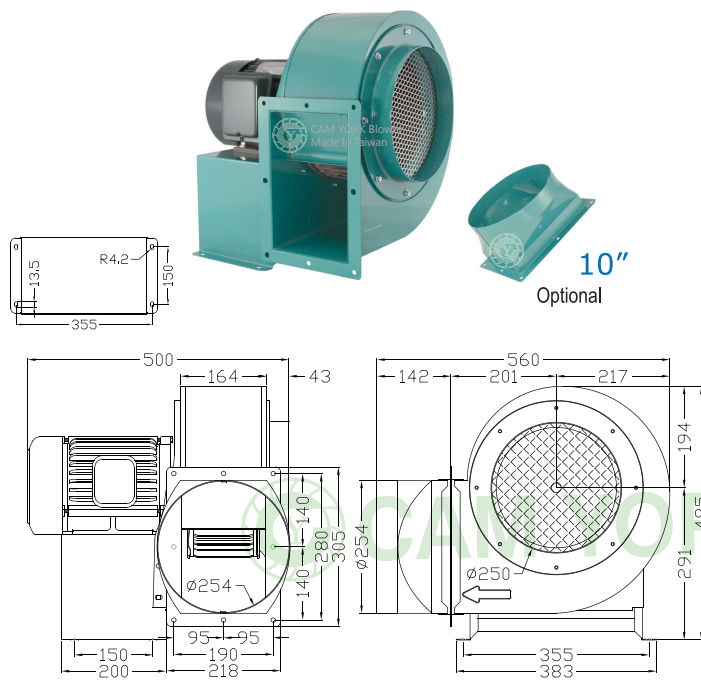

## CY270PV

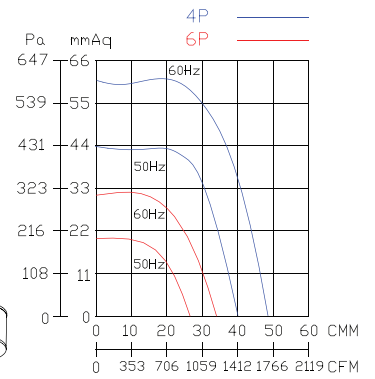
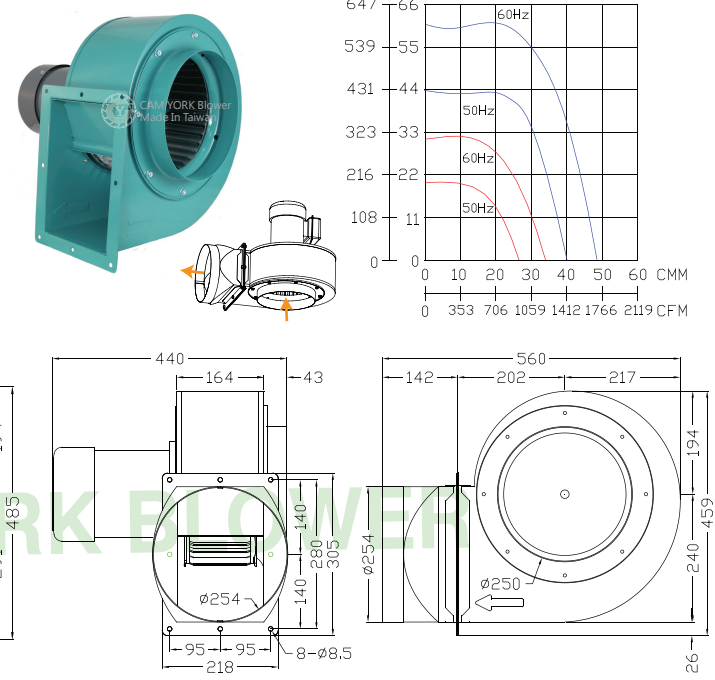

型號	電壓	頻率	相數	極數	電流	馬力	轉速	最大風量			最大靜壓			重量	
Model	Rated Voltage	Frequency	Phase	Pole	Current	Power	Speed	Max. Air Flow			Max. Pressure			Weight	
	V	Hz	∅	P	A	Watt / HP	R.P.M.	CMM	CMH	CFM	mmAq	inchAq	Pa	KG	
CY230P	110/220	50	1	4	6 / 3	1/2 HP	1450	21	1260	741	35	1.38	343	20	
		60			6 / 3		1700	25	1500	883	50.5	1.99	495		
CY230PV	220/380	50	3		2 / 1.2	1/4 HP	1450	21	1260	741	35	1.38	343		15.2
		60			2 / 1.2		1700	25	1500	883	50.5	1.99	495		
CY270P	110/220	50	1	6	4.6 / 2.5	1/4 HP	945	14	840	494	15.5	0.61	152	17	
		60			3.2 / 1.6		1160	17	1020	600	22	0.87	216		
CY270PV	220/380	50	3		13 / 6.5	1 HP	1475	40	2400	1412	44	1.73	432		26.6
		60			15 / 7.5		1740	48.3	2898	1705	63	2.48	618		
CY270PV	110/220	50	1	3.0 / 1.8	1/2 HP	1430	40	2400	1412	44	1.73	432	21.7		
		60		3.5 / 2.0		1660	47	2820	1659	63	2.48	618			
					6 / 3		970	27	1620	953	19	0.75	186		
					6 / 3		1150	32	1920	1130	27.5	1.08	270		

# P & PV Series (4 Pole & 6 Pole)

## CY310P

## CY310PV

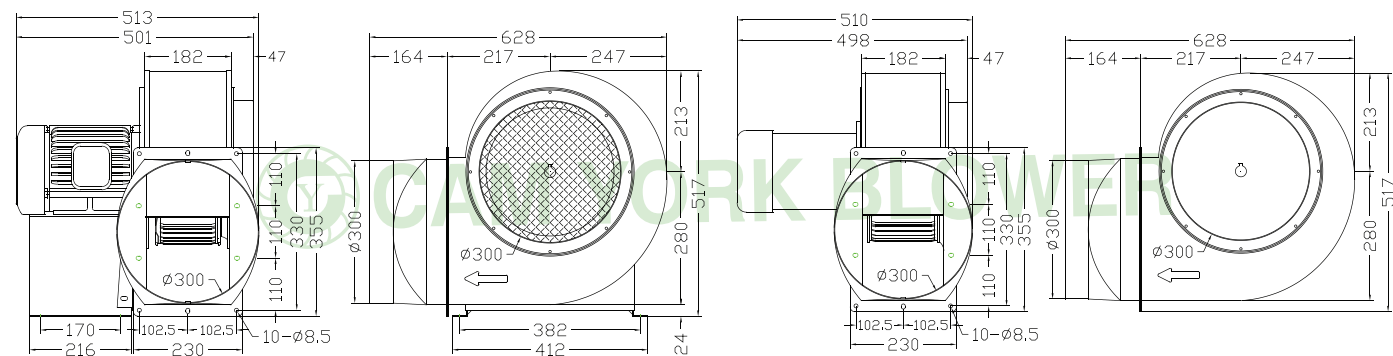

## CY350P



**2HP , 6Pole  
5HP , 4Pole**

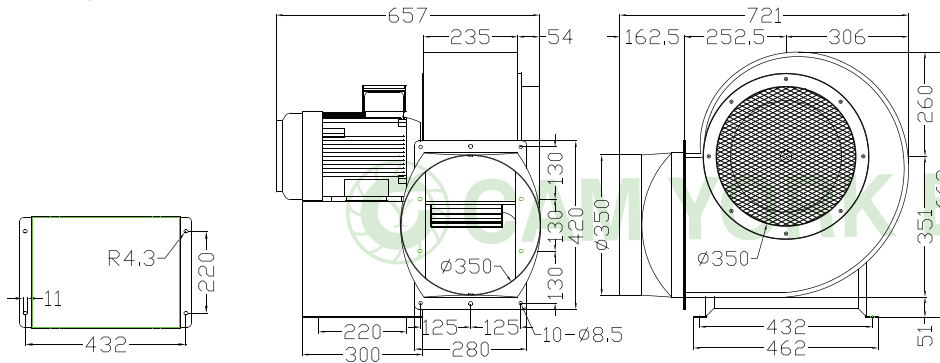
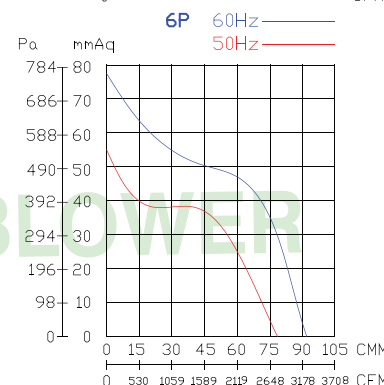
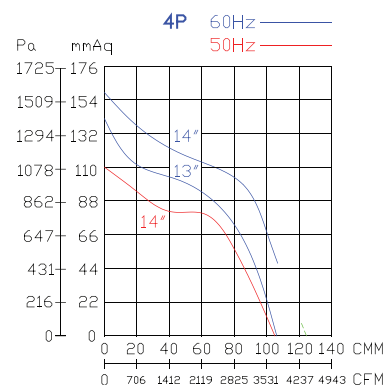

型號	電壓	頻率	相數	極數	電流	馬力	轉速	最大風量			最大靜壓			重量
Model	Rated Voltage	Frequency	Phase	Pole	Current	Power	Speed	Max. Pressure			Max. Air Flow			Weight
	V	Hz	∅	P	A	Watt / HP	R.P.M.	CMM	CMH	CFM	mmAq	inchAq	Pa	KG
CY310P CY310PV	220/380	50	3	4	6.2 / 3.3	2 HP	1460	60.1	3606	2122	74	2.91	726	42
					6.65 / 3.6	不可空吹 2HP-156H	1700	68	4080	2400	106	4.17	1040	
		60		6	6.65 / 3.6	可空吹 2HP-148H	1700	62	3720	2189	105	4.13	1030	
					7.6 / 4.6	3 HP	1750	71	4260	2506	106	4.17	1040	
CY350P	220/380	50	3	6	7 / 3.6	1 HP	980	43	2580	1518	29	1.14	284	39
					8.2 / 4.2	1160	51	3060	1800	45	1.77	441		
		60		4	14.2 / 8.3	5HP-14" 不可空吹	1700	124	7440	4377	158	6.22	1550	75
					13.2 / 7.6A	5HP-13" 可空吹	1750	106	6360	3742	140	5.51	1373	
60	6	6.2 / 3.6	2 HP	960	78	4680	2753	53	2.09	520	73			
		7.2 / 4.1	1100	92	5520	3248	74	2.91	726					

## CY380P



**2HP , 8Pole**  
**3HP , 6Pole**

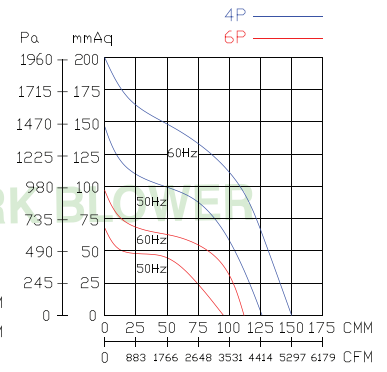
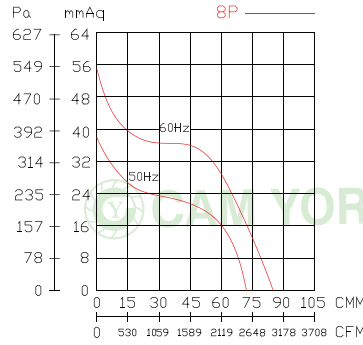

**7.5HP , 4Pole**

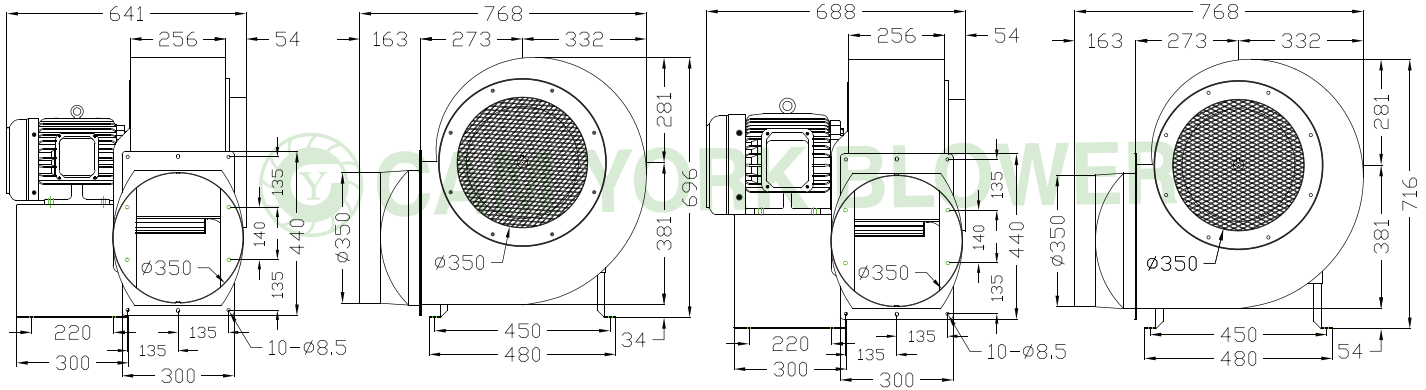

型號	電壓	頻率	相數	極數	電流	馬力	轉速	最大風量			最大靜壓			重量
Model	Rated Voltage	Frequency	Phase	Pole	Current	Power	Speed	Max. Air Flow			Max. Pressure			Weight
	V	Hz	Ø	P	A	Watt / HP	R.P.M.	CMM	CMH	CFM	mmAq	inchAq	Pa	KG
CY380P	220/380	50	3	4	15 / 8.5	7.5 HP	1470	126	7560	4448	146	5.75	1432	105
		60			20.5 / 12.5		1755	150	9000	5295	210	8.27	2059	
		50		6	7.1 / 4.1	3 HP	975	95	5700	3354	67	2.64	657	
		60			9.1 / 5.1		1145	111	6660	3918	97	3.82	951	
		50		8	2 HP	7.3 / 4.1	740	72	4320	2542	38	1.50	373	
		60				6.5 / 3.7	885	85	5100	3001	55	2.17	539	

## CY076M

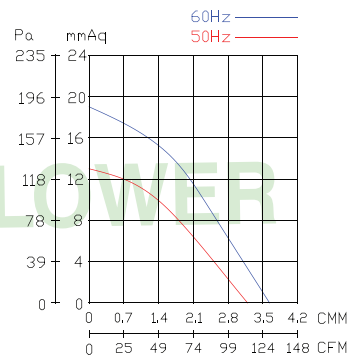
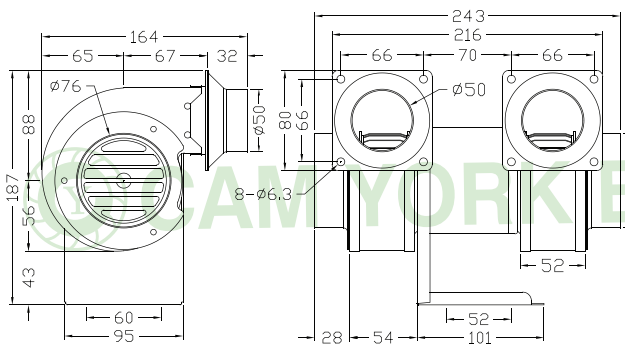
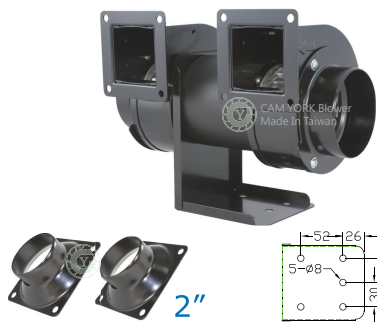

## CY100M

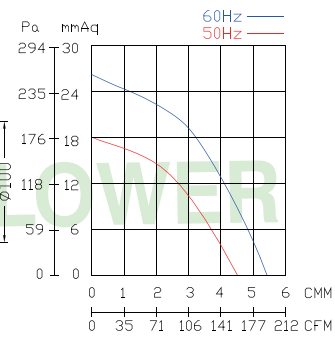
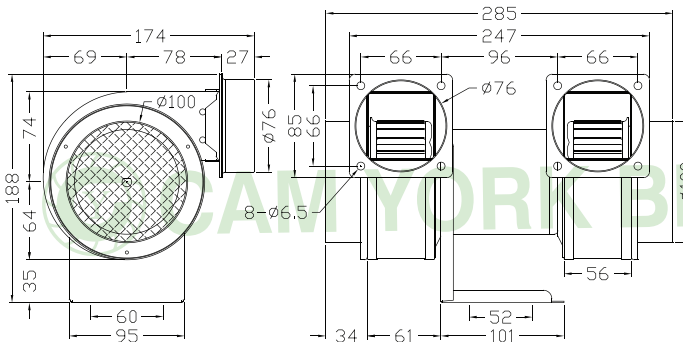

## CY120M

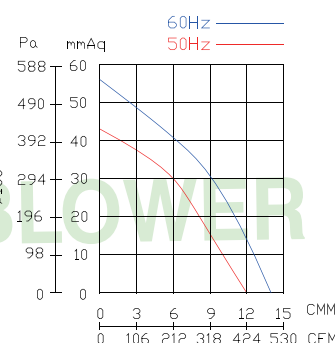
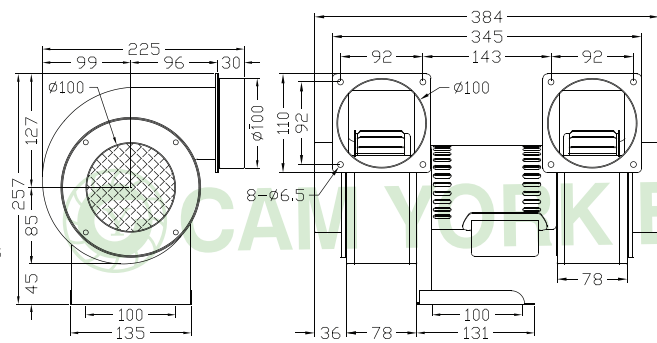
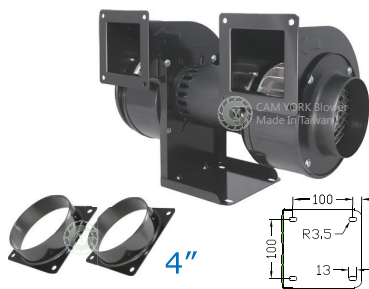

## CY125M

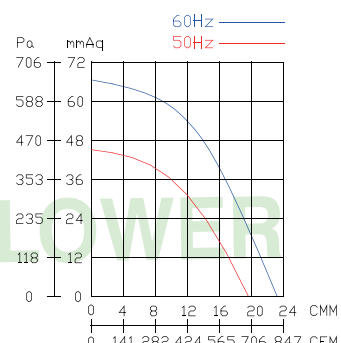
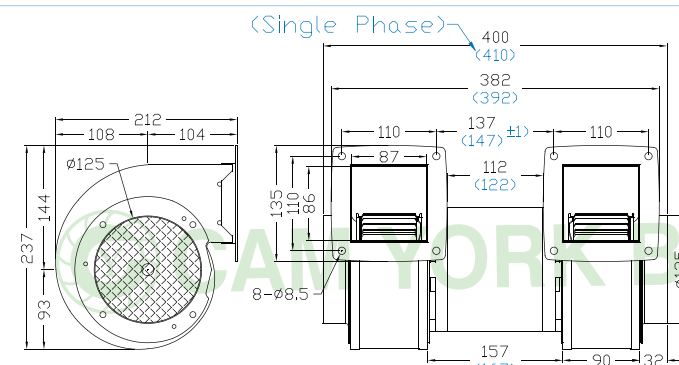

型號	電壓	頻率	相數	極數	電流	馬力	轉速	最大風量			最大靜壓			重量
Model	Rated Voltage	Frequency	Phase	Pole	Current	Power	Speed	Max. Air Flow			Max. Pressure			Weight
	V	Hz	∅	P	A	Watt / HP	R.P.M.	CMM	CMH	CFM	mmAq	inchAq	Pa	KG
CY076M	110/220	50	1	2	0.65 / 0.30	45 W	2860	3.2	192	113	13	0.51	127	3
		60			0.50 / 0.30		3400	3.6	216	127	19	0.75	186	
CY100M	110/220	50	1	2	0.72 / 0.38	50 W	2840	4.4	264	155	18	0.71	177	3.3
		60			0.72 / 0.38		3250	5.4	324	191	26	1.02	255	
CY120M	110/220	50	1	2	2.5 / 1.3	200 W	2900	12	720	424	43	1.69	422	6.7
		60			2.7 / 1.5		3400	14	840	494	56	2.20	549	
	220/380	50	3	0.9 / 0.5	2900		12	720	424	43	1.69	422		
		60		0.9 / 0.5	3400		14	840	494	56	2.20	549		
CY125M	110/220	50	1	2	4 / 2	1/2 HP	2930	19	1140	671	46	1.81	451	12.6
		60			5.0 / 2.5		3470	23.2	1392	819	66.5	2.62	652	
	220/380	50	3	2 / 1	2930		19	1140	671	46	1.81	451	11.6	
		60		2 / 1	3470		23.2	1392	819	66.5	2.62	652		

## CY150M

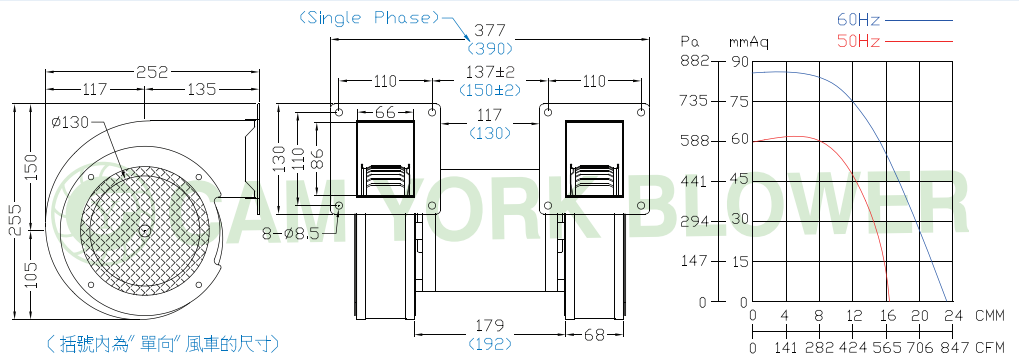

## CY180M

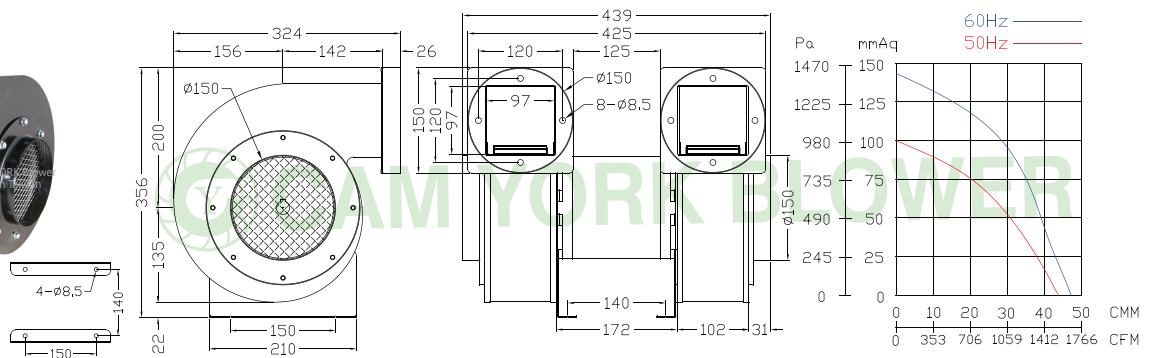
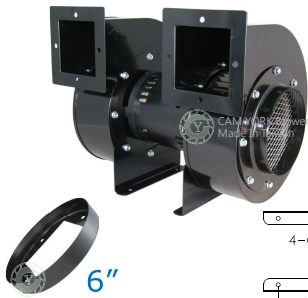

# DM Series

## CY125DM

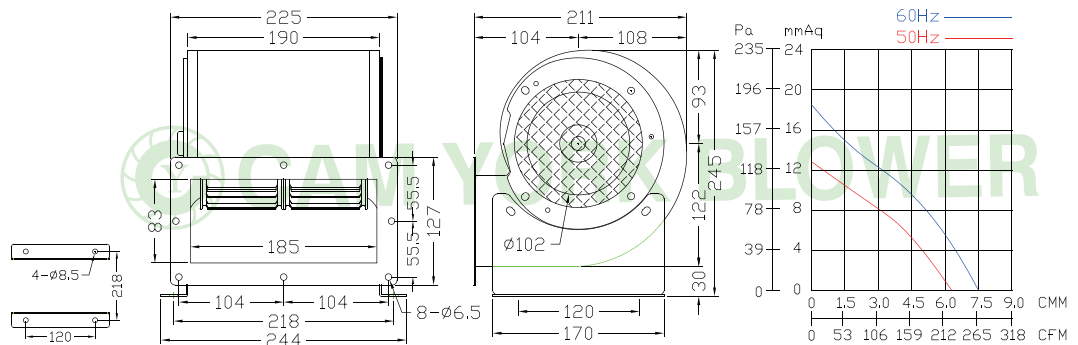

## CY150DM

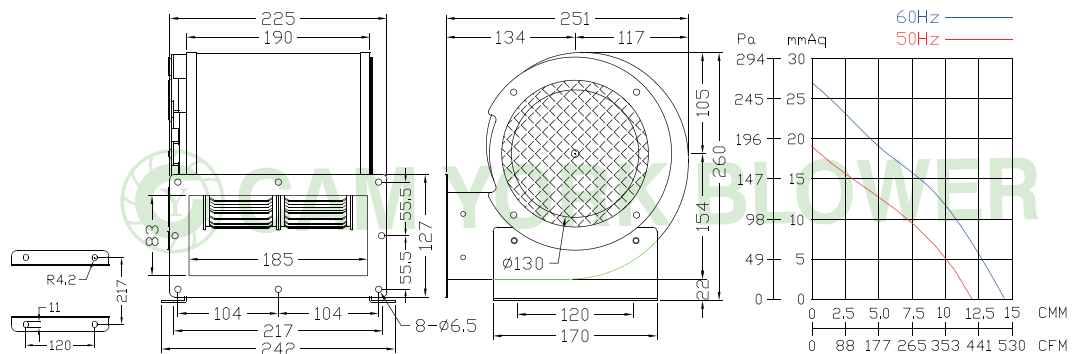

型號	電壓	頻率	相數	極數	電流	馬力	轉速	最大風量			最大靜壓			重量
Model	Rated Voltage	Frequency	Phase	Pole	Current	Power	Speed	Max. Air Flow			Max. Pressure			Weight
	V	Hz	Ø	P	A	Watt / HP	R.P.M.	CMM	CMH	CFM	mmAq	inchAq	Pa	KG
CY 150M	110/220	50	1	2	5.0 / 2.5	3/4 HP	2900	17.6	1056	621	60	2.36	588	13
		60			7.6 / 3.8		3450	23	1380	812	85	3.35	834	
	220/380	50	3	2.5 / 1.5	2900		17.6	1056	621	60	2.36	588		
		60		2.6 / 1.5	3450		23	1380	812	85	3.35	834		
CY 180M	220/380	50	3	2	4.4 / 2.5	1.5 HP	2900	43	2580	1518	100	3.94	981	19
		60			6.0 / 3.5		3300	48.7	2922	1719	143	5.63	1402	
CY 125DM	110/220	50	1	4	0.8 / 0.4	70 W	1330	6.3	378	222	12.8	0.50	126	4.7
		60			0.7 / 0.4		1600	7.5	450	265	18.5	0.73	181	
CY 150DM	110/220	50	1	4	1.6/0.8	110 W	1400	12	720	424	19	0.75	186	5.5
		60			1.5/0.8		1600	14.4	864	508	27	1.06	265	

## CY178DM

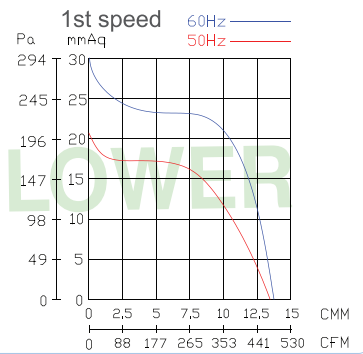
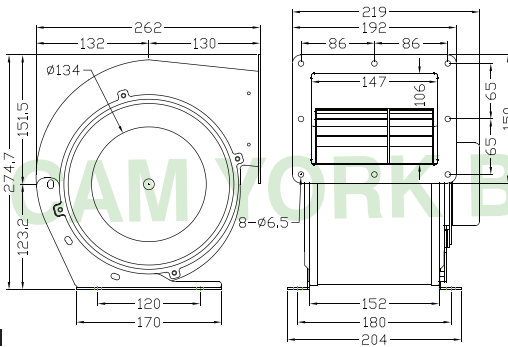
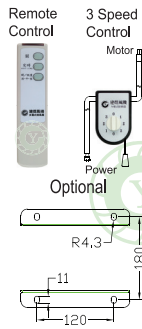

• 可變換3速/可遙控 // 3 Speed motor / Remote Control

## CY190DM

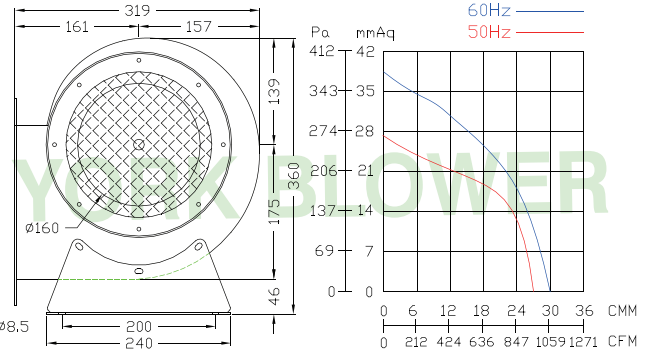
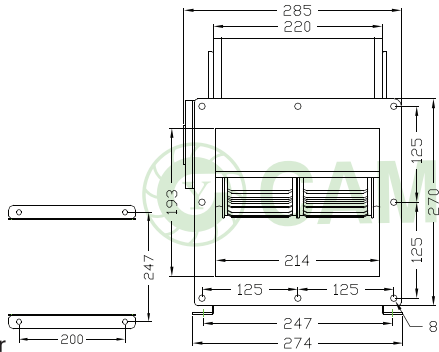

• 可變換3速/3 Speed motor

## CY200DM

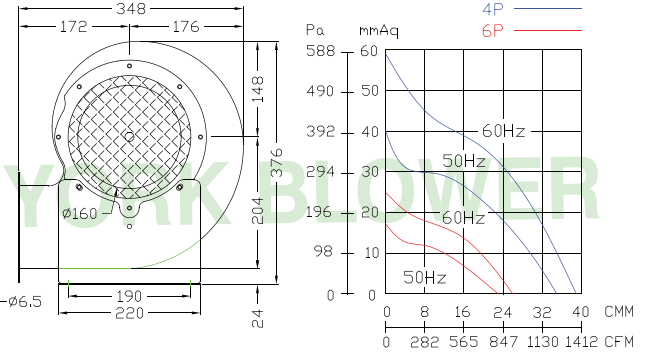
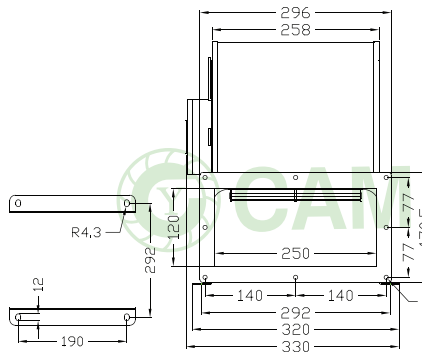

## CY230DM

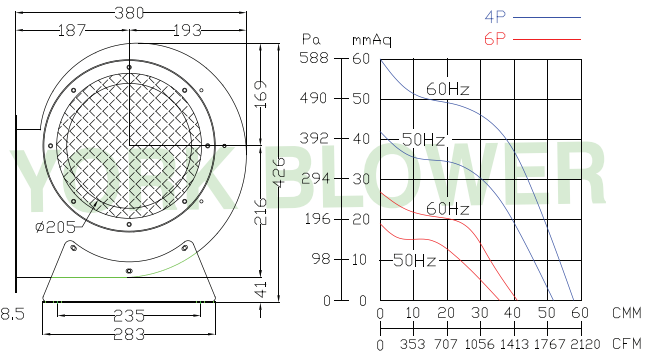
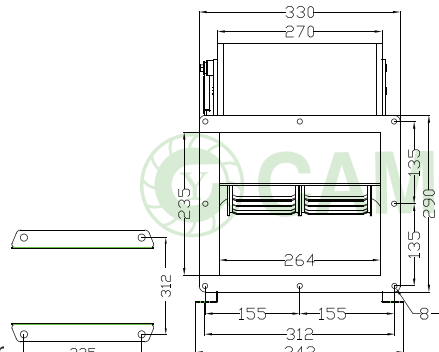

• 可變換3速/3 Speed motor

型號	電壓	頻率	相數	極數	電流	馬力	轉速	最大風量			最大靜壓			重量
Model	Rated Voltage	Frequency	Phase	Pole	Current	Power	Speed	Max. Air Flow			Max. Pressure			Weight
	V	Hz	∅	P	A	Watt / HP	R.P.M.	CMM	CMH	CFM	mmAq	inchAq	Pa	KG
CY178DM	110/220	50	1	4	1.3 / 0.7	75 W	1150	13.4	804	473	21.4	0.84	210	5.3
		60			1.6 / 0.8		1170	13.6	816	480	30	1.18	294	
CY190DM	110/220	50	1	4	4.0 / 2.0	420 W	1400	27.5	1650	971	27	1.06	265	10.6
		60			5.0 / 2.5		1600	30	1800	1059	38	1.50	373	
	220/380	50	3	1.3 / 0.7	1400		27.5	1650	971	27	1.06	265		
		60		1.4 / 0.8	1600		30	1800	1059	38	1.50	373		
CY200DM	110/220	50	4	4	5.2 / 2.6	400 W	1360	35	2100	1236	40	1.57	392	12.4
		60			6.6 / 3.6		1450	39	2340	1377	59	2.32	579	
		60	6	1.8 / 0.9	900	23	1380	812	17	0.67	167			
				2.0 / 1.0	980	26	1560	918	25	0.98	245			
CY230DM	220	50	1	4	3.7	550 W	1400	52	3120	1836	42	1.65	412	19
		60			5.5		1600	58	3480	2047	60	2.36	588	
	220/380	50	3	3 / 1.7	1400	52	3120	1836	42	1.65	412	15		
		60		4 / 2.3	1600	58	3480	2047	60	2.36	588			
	110/220	50	1	6	3.3 / 1.7	400 W	900	36	2160	1271	19	0.75	186	14.2
		60			4.1 / 2.3		1100	41	2460	1447	27	1.06	265	

## CY270DM



- 可變換3速/3 Speed motor

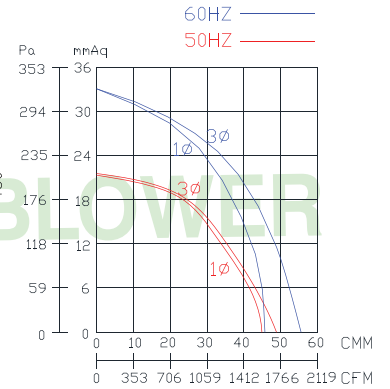
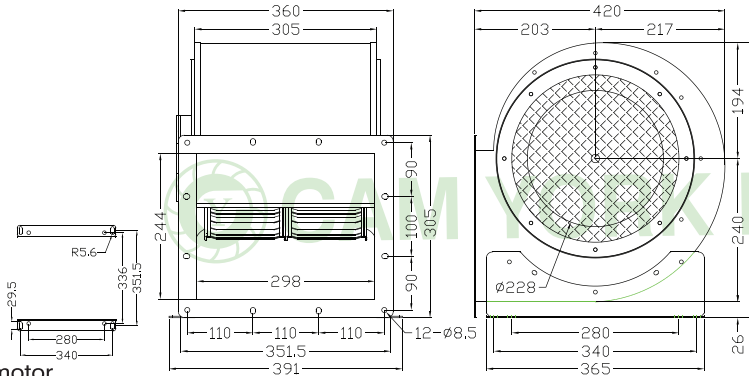

## CY275DM



- 可變換3速/3 Speed motor

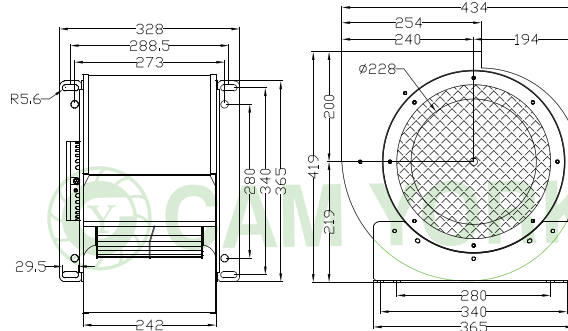

上視圖 (Top View)

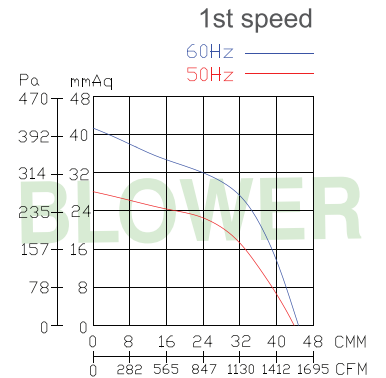

## CY280DM



- 可變換3速/3 Speed motor

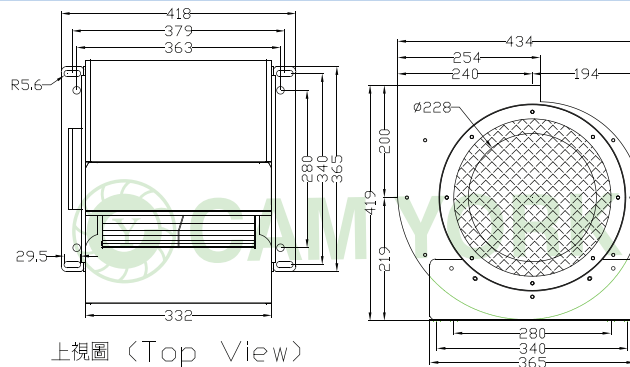

上視圖 (Top View)

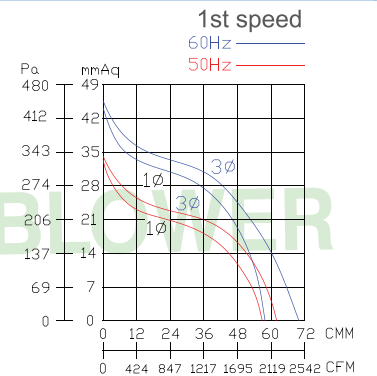

## CY310DM

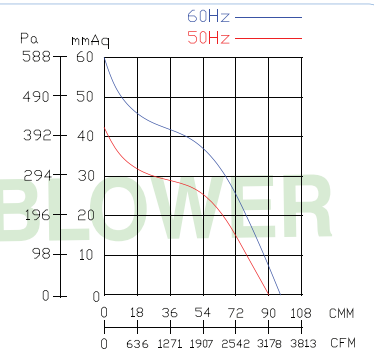
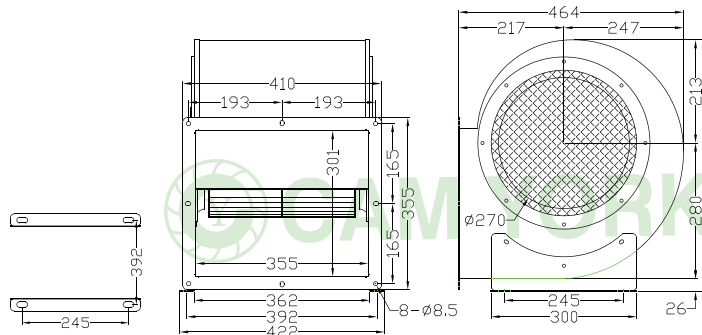

型號	電壓	頻率	相數	極數	電流	馬力	轉速	最大風量			最大靜壓			重量			
Model	Rated Voltage	Frequency	Phase	Pole	Current	Power	Speed	Max. Air Flow			Max. Pressure			Weight			
	V	Hz	$\phi$	P	A	Watt / HP	R.P.M.	CMM	CMH	CFM	mmAq	inchAq	Pa	KG			
CY270DM	110/220	50	1	6	6.1 / 3.0	3/4 HP	880	45	2700	1589	22	0.87	216	19.7			
		60			6.6 / 3.6		910	47	2820	1659	33	1.30	324				
	220/380	50	3		3.2 / 1.8		950	48.5	2910	1712	22	0.87	216				
		60			3 / 1.6		1100	56.5	3390	1994	33	1.30	324				
CY275DM	110/220	50	1	6	6 / 2.6	1/2 HP	860	44	2640	1553	30	1.18	294	17			
		60			7 / 3.2		880	44.5	2670	1571	43	1.69	422				
CY280DM	110/220	50	1		6		6.5 / 3.0	3/4 HP	880	57.8	3468	2040	35		1.38	343	20
							8 / 4		885	58	3480	2047	45		1.77	441	
	220/380	50	3	3.7 / 2		940	62		3720	2189	35	1.38	343				
				60		4 / 2.3	1050		69	4140	2436	45	1.77	441			
CY310DM	220/380	50	3	6	4 / 2.4	700 W	900	90	5400	3177	42	1.65	412	26.7			
		60			5.6 / 3.1		970	96	5760	3389	60	2.36	588				

## CY350DM

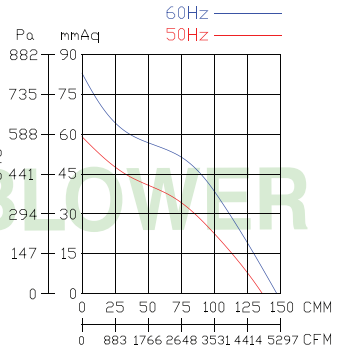
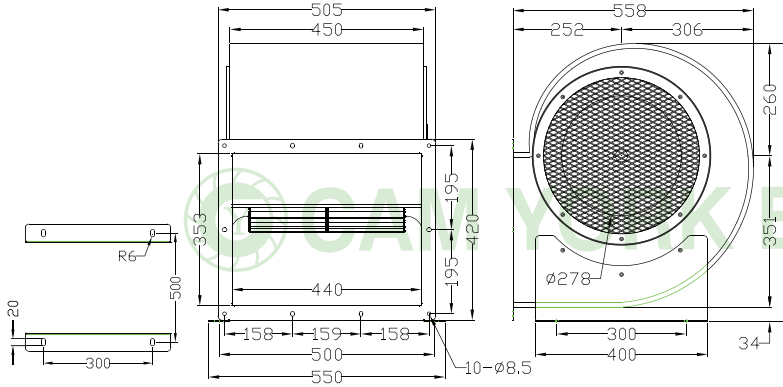

## CYS Series

### CYS190



• 可變換2速 / 2 Speed motor available

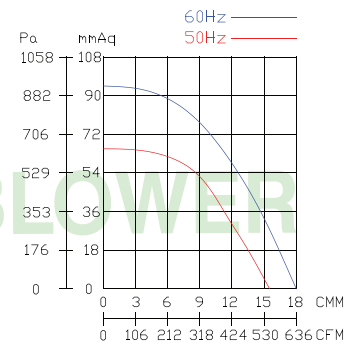
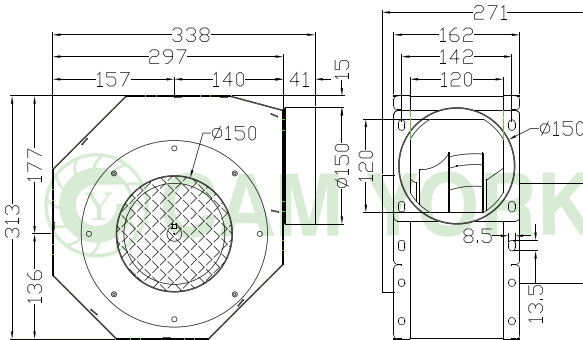

### CYS193

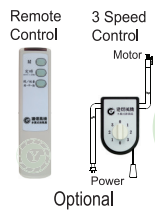

• 可變換3速/可遙控 // 3 Speed motor / Remote Control

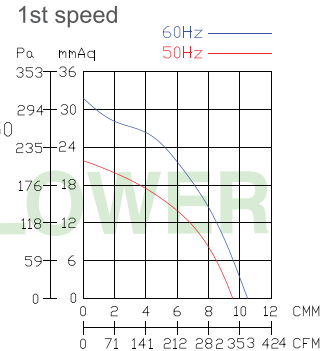
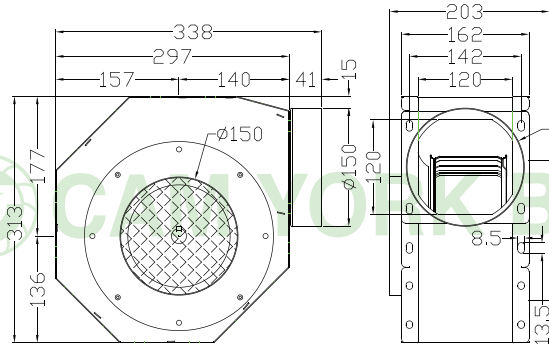

### CYS195

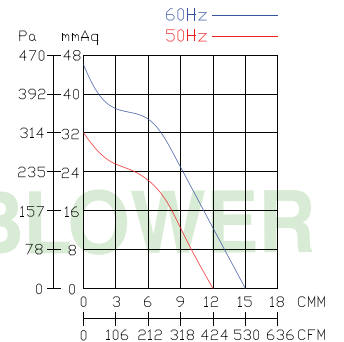
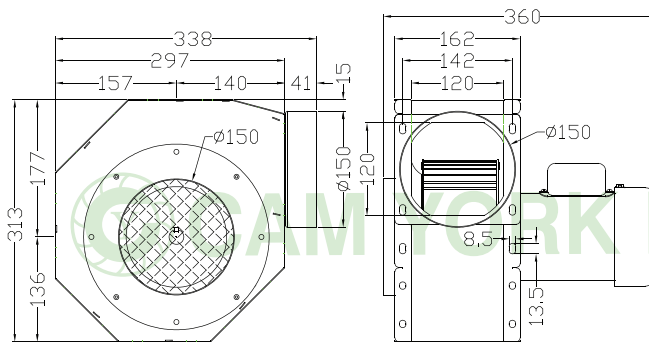

型號	電壓	頻率	相數	極數	電流	馬力	轉速	最大風量			最大靜壓			重量
Model	Rated Voltage	Frequency	Phase	Pole	Current	Power	Speed	Max. Air Flow			Max. Pressure			Weight
	V	Hz	Ø	P	A	Watt / HP	R.P.M.	CMM	CMH	CFM	mmAq	inchAq	Pa	KG
CY350DM	220/380	50	3	6	8 / 4.8	2 HP	920	132	7920	4660	59	2.32	579	48
		60			11.3 / 6.2		1000	146	8760	5154	83	3.27	814	
CYS190	110/220	50	1	2	3.8 / 1.9	1/2 HP	2900	15.5	930	547	66	2.60	647	10.4
		60			4.4 / 2.2		3400	18	1080	635	94	3.70	922	
CYS193	110/220	50	1	4	1.1 / 0.6	75 W	1300	9.5	570	335	22	0.87	216	5.7
		60			1.4 / 0.7		1450	10.5	630	371	32	1.26	314	
CYS195	110/220	50	1	4	3 / 1.5	1/4 HP	1460	12	720	424	32	1.26	314	11.4
		60			2.5 / 1.25		1720	15	900	530	46	1.81	451	





## CYB120

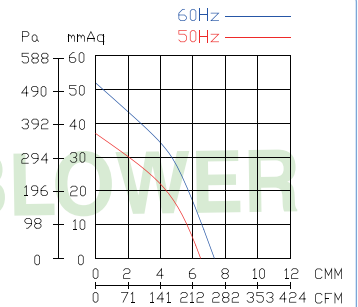
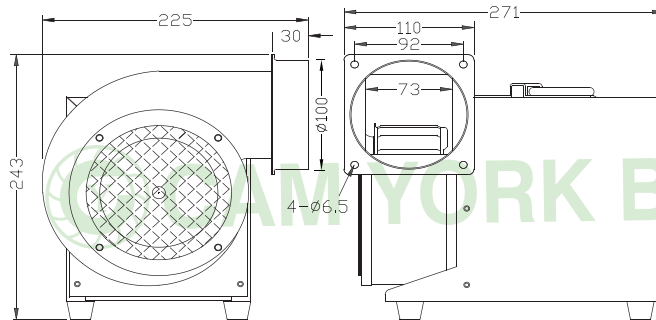

## CYB125

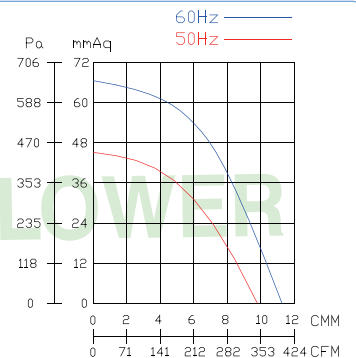
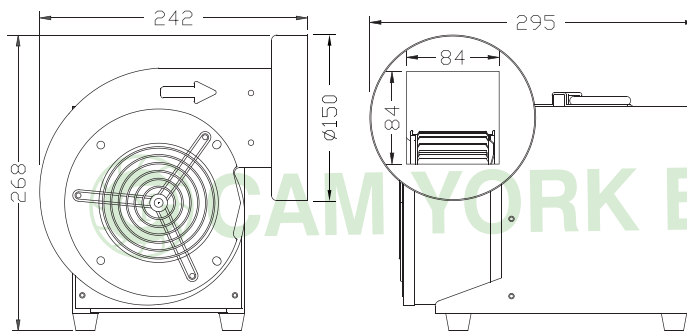

## CYB127

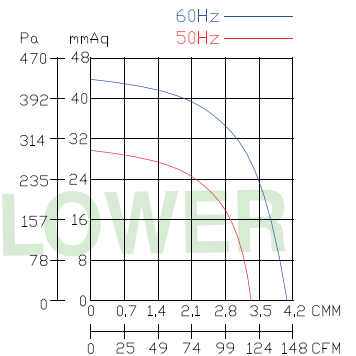
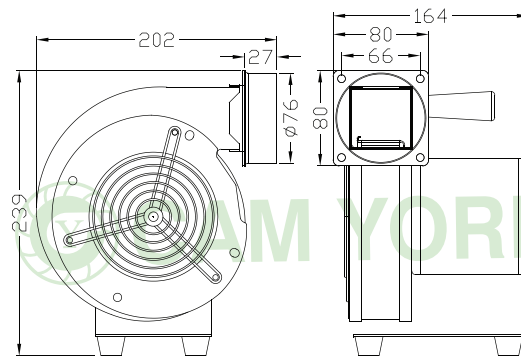

## CYB180

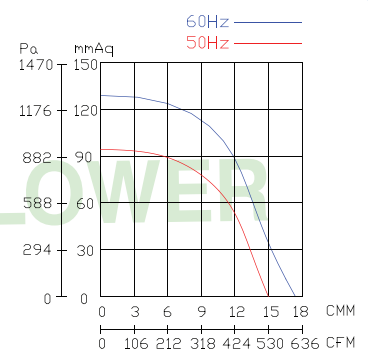
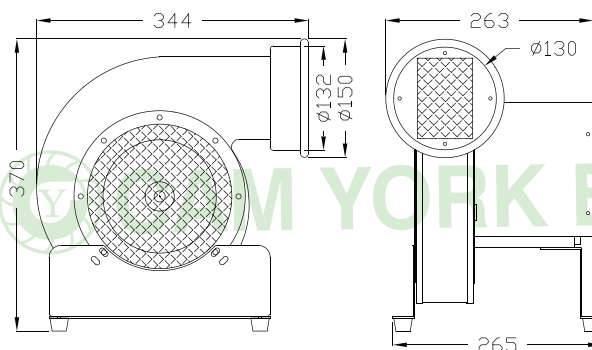

型號	電壓	頻率	相數	極數	電流	馬力	轉速	最大風量			最大靜壓			重量
Model	Rated Voltage	Frequency	Phase	Pole	Current	Power	Speed	Max. Air Flow			Max. Pressure			Weight
	V	Hz	∅	P	A	Watt / HP	R.P.M.	CMM	CMH	CFM	mmAq	inchAq	Pa	KG
CYB120	110/220	50	1	2	1.3 / 0.65	1/8 HP	2870	6.4	384	226	37	1.46	363	5.8
		60			1.3 / 0.65		3330	7.3	438	258	52	2.05	510	
CYB125	110/220	50	1	2	2.5 / 1.4	200 W	2800	9.5	570	335	46	1.81	451	7.4
		60			3.0 / 1.5		3485	11.6	696	409	66.4	2.61	651	
CYB127	110/220	50	1	2	0.9 / 0.45	50 W	2840	3.3	198	116	30.5	1.20	299	3.7
		60			0.9 / 0.45		3220	4	240	141	44	1.73	432	
CYB180	110/220	50	1	2	6 / 3	1/2 HP	2840	15	900	530	92	3.62	902	13.2
		60			8 / 4		3250	17	1020	600	130	5.12	1275	

## CY076DC Brushless

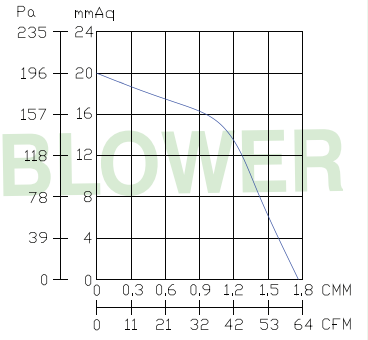
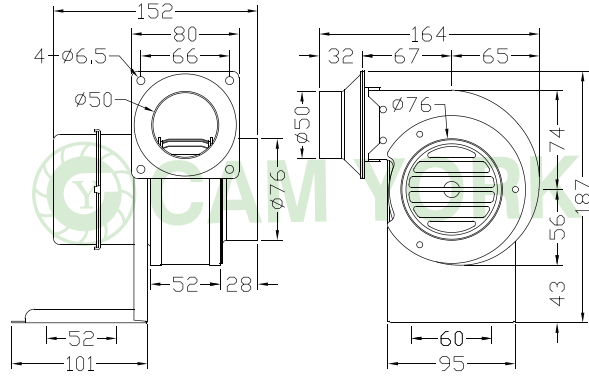
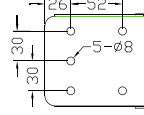

## CY100DC Brushless

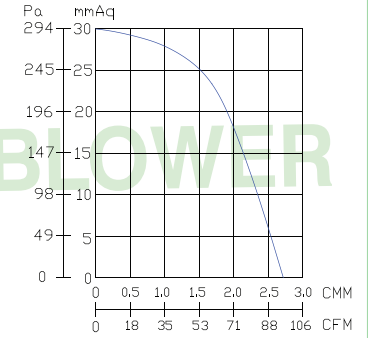
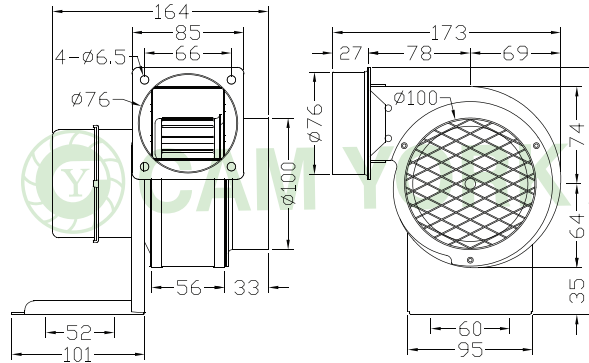
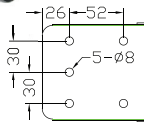

## CY120EC Brushless

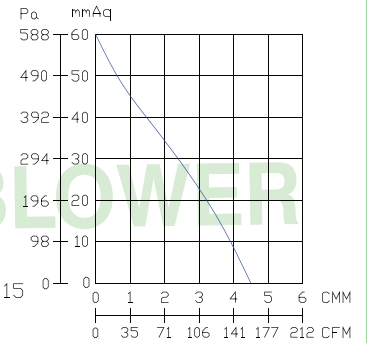
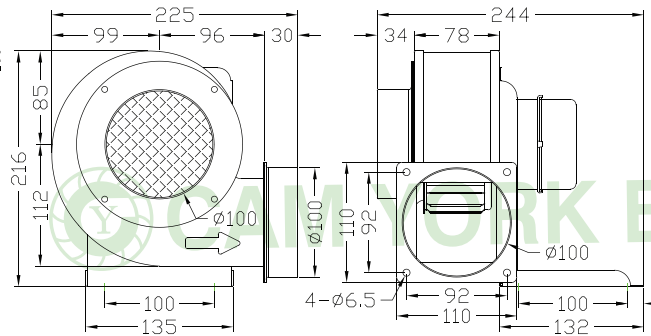
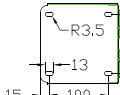

Input: DC24V or AC110V/220V

## CY120DC-3500 Brushless

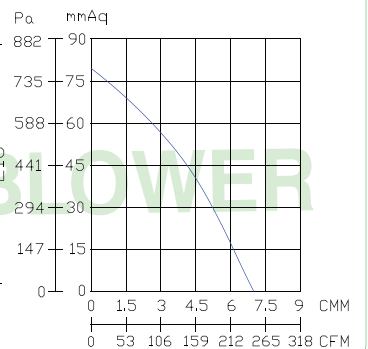
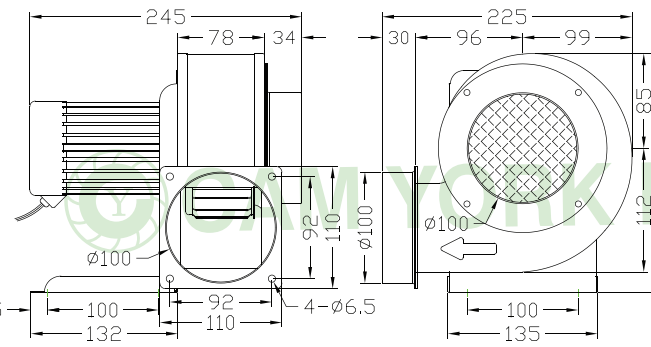
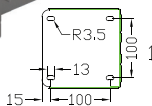
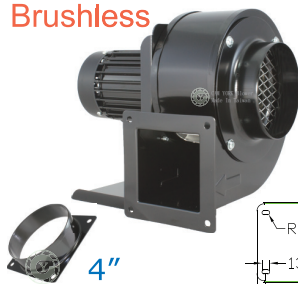

型號	電壓	電流	轉速	最大風量			最大靜壓			重量
Model	Rated Voltage	Current	Speed	Max. Air Flow			Max. Pressure			Weight
	V	A	R.P.M.	CMM	CMH	CFM	mmAq	inchAq	Pa	KG
CY076DC	24	1.7	3700	1.7	102	60	20	0.79	196	1.7
CY100DC	24	2.2	3350	2.7	162	95	30	1.18	294	1.9
CY120EC	DC 24	2.2	2300	4.5	270	159	60	2.36	588	2.5
	AC110 / 220	0.85 / 0.5								
CY120DC-3500	24	5.6	3500	7	420	247	78	3.07	765	3.2



## Smoke Collection Blower / 煙罩式風機

### CYC380

#### Material / 材質:

- 材質：白鐵 sus304.
- Material : Stainless steel. sus 304.

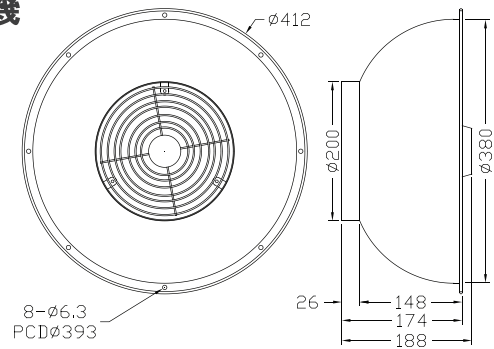

型號	電壓	頻率	相數	極數	電流	馬力	轉速	最大風量			最大靜壓			重量
Model	Rated Voltage	Frequency	Phase	Pole	Current	Power	Speed	Max. Air Flow			Max. Pressure			Weight
	V	Hz	Ø	P	A	Watt / HP	R.P.M.	CMM	CMH	CFM	mmAq	inchAq	Pa	KG
CYC380	110	60	1	2	0.72	50 w	3200	14	840	494	10	0.39	98	2.5

## CYW250

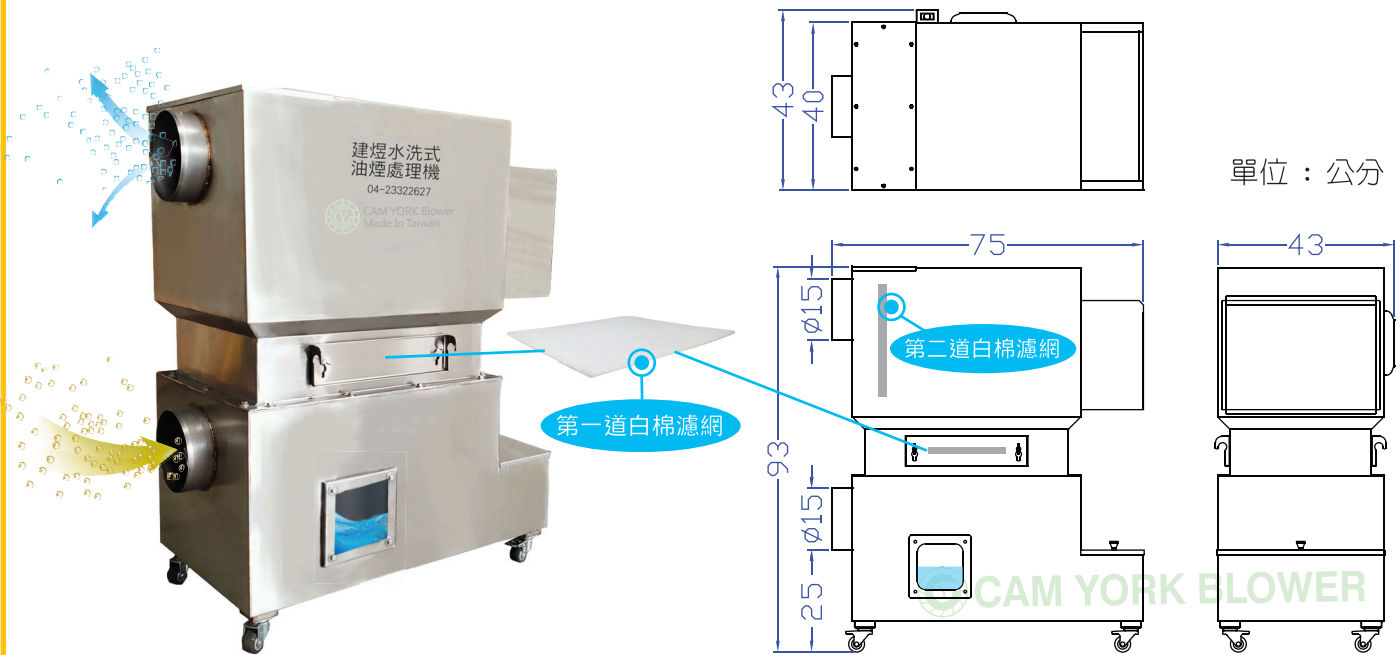

建議白棉濾網更換時間：  
第一道白棉濾網：一個月  
第二道白棉濾網：一年



### 產品特色

- 1.適用於油炸機，早餐店，夜市餐廚，產業機械.
- 2.特殊水洗風道設計，水瀑式洗滌，淨化效果佳.
- 3.白棉濾網設計，低成本，簡易更換.
- 4.內含透浦式風機，風壓大，效果佳.
- 5.白鐵自動補水箱設計，可不需另接水源.
- 6.無泵浦無噴嘴設計，不需再花費保養.
- 7.全機使用SUS304白鐵(風機除外).
- 8.全機百分百台灣製造.
- 9.馬達有溫控保護開關.



### 規格

- 1.抽風機馬力：1/2HP
- 2.接風管尺寸：6英吋（15公分）
- 3.最大排風量：100MM
- 4.額定電流：5A
- 5.水箱容量：30公升
- 6.淨重：54kg
- 7.外型尺寸：75公分x43公分x高93公分

# 多翼式排風扇

## CYV400

可接風管，換氣更具彈性，不會直接將廢氣排出影響鄰居  
適用於氣窗、神明廳、廚房、小吃店、地下室等室內場所之換氣。

- 可接風管
- 大風量 (700CMH 第一速)
- 三段風量
- 溫控保護
- 無線遙控定時關機 (選配)
- 雙滾珠軸承

### 產品特色

- 1 搭配三速切換開關，附拉繩設計，調速輕鬆又便利。
- 2 全機金屬輕量化設計，堅固耐用。
- 3 強力工業用電容式馬達，雙滾珠軸承，馬達無聲運轉更持久。
- 4 超強排風量，每小時700CMH，更佳換氣效果。
- 5 高規格安全防護，搭載馬達溫度保護開關裝置，安全有保障。
- 6 可選配三速(強-中-弱)遙控，三段定時關機，操作更EASY。
- 7 全機100%台灣製造，MIT品質有保障。
- 8 馬達可選擇靜音型，提供更舒適靜音的通風環境。

負壓式排風設計  
達到最佳通風效果  
常保潔淨空氣

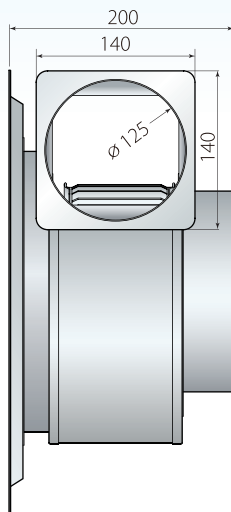
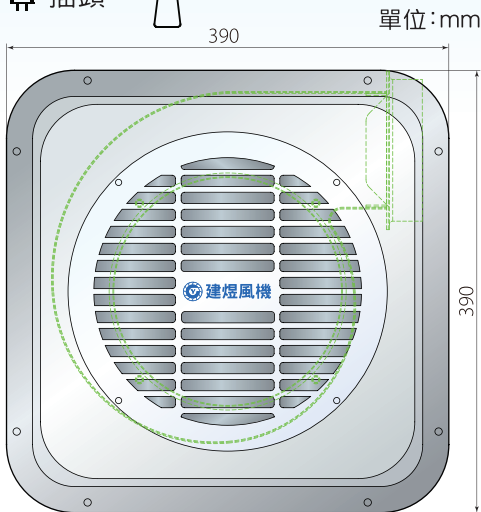

MODEL		CYV400 通用型		
調速		強	中	弱
電壓	V	110 或 220		
頻率	Hz	60		
最大排風量	CMH	700	480	330
最大靜壓	mmAq	30	28	26
消耗電力	W	143	115	70
噪音	dB	59	52	43
出風口	英吋	5" (125mm)		
尺寸	mm	400 x 400 x 200		
重量	kg	5.5		

### 選配項目

#### 靜音型規格

CYV-400		強	中	弱
最大排風量	CMH	500	390	330
最大靜壓	mmAq	16	15	14
消耗電力	W	70	45	35
噪音	dB	52	45	41

#### 無線遙控樣式

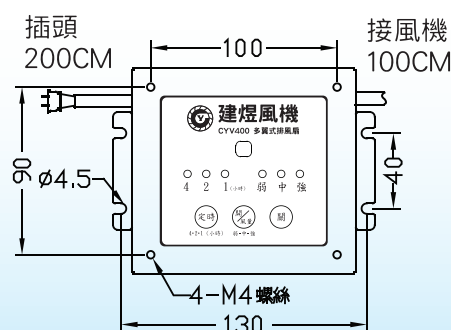

## 輕鋼架型

# 多翼式排風扇

## CYV600



### 產品特色

利用負壓式排風設計  
達到最佳通風效果  
常保潔淨空氣

- 1 多樣選擇，可接風管、排風更具彈性，達到真正換氣效果。
- 2 全機金屬輕量化設計，堅固耐用(面板和出風口除外)。
- 3 強力工業用電容式馬達，超強排風，雙滾珠軸承，馬達無聲運轉更持久。
- 4 高規格安全防護，搭載馬達溫度保護開關裝置，安全有保障。
- 5 逆止閥風門設計，可大幅減少髒空氣及異味或蚊蟲竄入。
- 6 紅外線遙控三速，(強-中-弱)燈號顯示操作更 EASY (可選配三速切換開關)。
- 7 定時關機功能，一小時、兩小時、四小時三段選擇，燈號顯示。
- 8 全機 100% 台灣製造，MIT 品質有保障。



大風量  
(700CMH  
第一速)

三段風量

三段定  
時關機

金屬材質

無線遙控

雙滾珠  
軸承

單位: mm

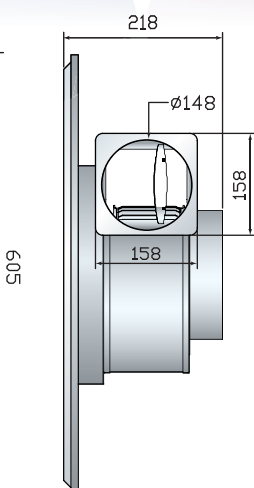
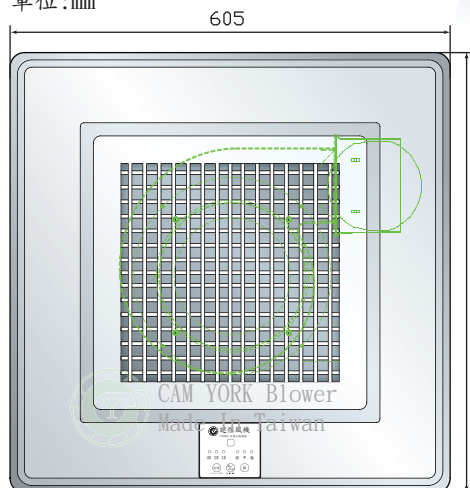

MODEL		CYV600 通用型		
調速		強	中	弱
電壓	V	110 或 220		
頻率	Hz	60		
最大排風量	CMH	700	480	330
最大靜壓	mmAq	30	28	26
消耗電力	W	148	115	70
噪音	dB	59	52	43
出風口	英吋	6" (148 mm)		
尺寸	mm	605 x 605 x 220		
重量	kg	6.2		

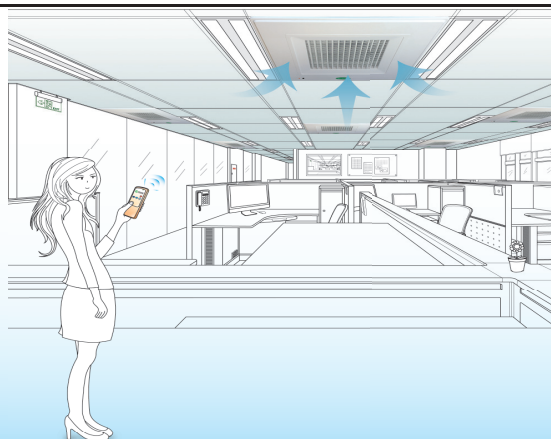

### 選配項目

標準型規格

三速切換開關  
(附拉繩)

CYV600		強	中	弱
最大排風量	CMH	500	390	330
最大靜壓	mmAq	16	15	14
消耗電力	W	70	45	35
噪音	dB	52	45	41



# CROSS FLOW FAN / 橫流扇

## AC shaded pole motor



### CRE Series

AC, Shaded pole motor  
Single Phase, 2 Pole  
Fan Wheel Dia.:030,040,  
043,050,060mm

## AC capacitor motor



### CREC Series

AC capacitor motor  
Single Phase, 2 Pole  
Outlet in horizontal line  
Fan Wheel Dia.:060mm



### CRVC Series

AC, Capacitor motor  
Single Phase, 2 Pole  
Outlet: 45 degree up  
Fan Wheel Dia.:060mm



### CRFC Series

AC, Capacitor motor  
Single Phase, 4 Pole  
Aluminum bar enhanced  
Fan Wheel Dia.:060,090,110,150mm

## DC motor



### CRED Series

DC Brushless, 12V, 24V  
Fan Wheel Dia.:025,030,040,  
043,050,060mm



### CRVD Series

DC Brushless, 12V, 24V  
Outlet: 45 degree up  
Fan Wheel Dia.:025,043mm



### CRSD Series

DC Brushless, 12V, 24V  
with fixture plate  
Fan Wheel Dia.:030mm



### CRQD Series

DC Brushless, 12V, 24V  
Extended outlet  
Fan Wheel Dia.:043,060,065mm





**CYH1**  
1/8HP



**CYH1A**  
1/8HP



**CYH2**  
1/4HP



**CYH2B**  
1/4HP



**CYH2C**  
1/4HP



**CYH3**  
1/2HP



**CYH4**  
1/2HP / 1HP



**CYH5**  
1/2HP



**CYH6**  
1HP



**CYH201 / 202**  
1/2HP / 1HP



**CYH8/ CYH9/ CYH10/ CYH11**  
2HP / 3HP / 5HP / 7.5HP



**CYH8L/ CYH9L/ CYH10L**  
2HP / 3HP / 5HP



**CYH104**  
2HP

### 用途：

吹塑膠袋, 塑膠印刷機, 分條機, 乾燥機, 吸塵, 製粉, 吸絲, 吸木屑, 電熱送風機, 一般機械之送排風裝置.

### IDEAL FOR :

Printing press, Plastic Extruder, Slitting Machine, Drying Oven, Dust Cleaner, Sawdust Remover, Electric Ventilator and Other Ventilating Device uses.



# CAM YORK BLOWER

Memo

Lined area for writing notes, consisting of 15 horizontal lines with rounded ends.



# CAM YORK BLOWER

Lined area for notes, consisting of 18 horizontal lines with rounded ends.

Memo



**建煜工業股份有限公司**  
**CAM YORK INDUSTRIAL CO., LTD.**

41348 台灣台中市霧峰區吉峰路63號  
No.63 Jifeng Rd., Wufeng Dist.,  
Taichung City 41348, TAIWAN  
Tel: 886-4-23322627 Fax: 886-4-23322629  
Website: <http://www.blower.com.tw>  
E-mail: [blower-cy@umail.hinet.net](mailto:blower-cy@umail.hinet.net)